



Güneş Makina[®]

Lifting Components



We Produce Quality



info@gunesmakina.com

www.gunesmakina.com

Product Catalog No: 3



Güneş Makina®



www.gunesmakina.com

INSPECCO
ISO 9001

TÜV
AUSTRIA

ДОБРОВОЛНА
ЦЕНТРАЛНА
СЕРТИФИКАЦИОНА

CE

TSE
Test Certification
NDT

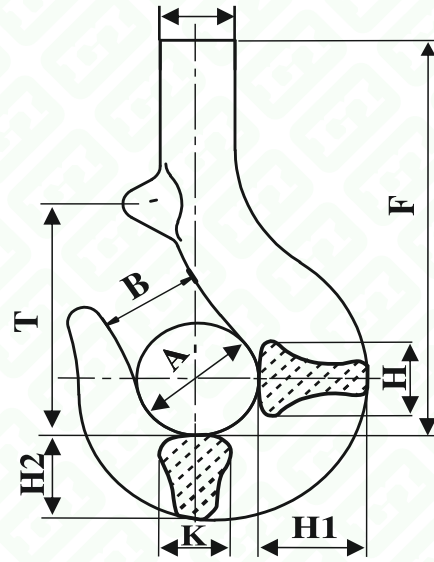

Shank Hook DIN (GM 15401)

Nr	Dimensions									Weight Kg/Pcs
	A	B	D	F	H	H1	H2	K	T	
025	36	28	20	152	22	28	25	20	75	0.74
05	42	34	25	172	30	38	31	26	95	1.4
08	48	38	30	191	37	44	37	32	103	2.3
1	50	40	32	206	41	48	40	35	108	2.6
1.6	56	45	36	233	46	56	48	40	119	4.32
2.5	63	50	42	263	56	67	58	48	135	6.95
4	71	56	48	297	65	80	67	54	152	9.9
5	80	63	55	332	73	90	75	62	170	13.6
6	91	72	62	390	80	100	86	67	195	20.4
8	101	81	67	435	92	113	96	76	213	28.8
10	118	93	77	490	105	125	110	90	225	39
12	130	106	88	540	114	140	123	105	250	62
16	145	114	97	615	130	168	132	118	290	95
20	165	130	110	680	140	184	156	120	340	135
25	180	140	124	750	160	200	170	132	360	150
32	200	170	136	830	180	240	190	160	420	200
40	230	180	155	930	200	250	215	170	440	310
50	250	210	175	1000	224	280	236	190	485	430

* Please contact us for other materials and for dimensions of the special products.
 ** Our products have been certified according to EC regulations, they have CE mark.
 *** All of our products are being tested according to relevant standards by using test devices which are calibrated by TSE.
 If requested, all tests are done under supervision of GLIS' inspector and reported by GLIS.
 Forged With Latch
 Material : P=S355, S-T=42crMo4, V=34crNiMo6

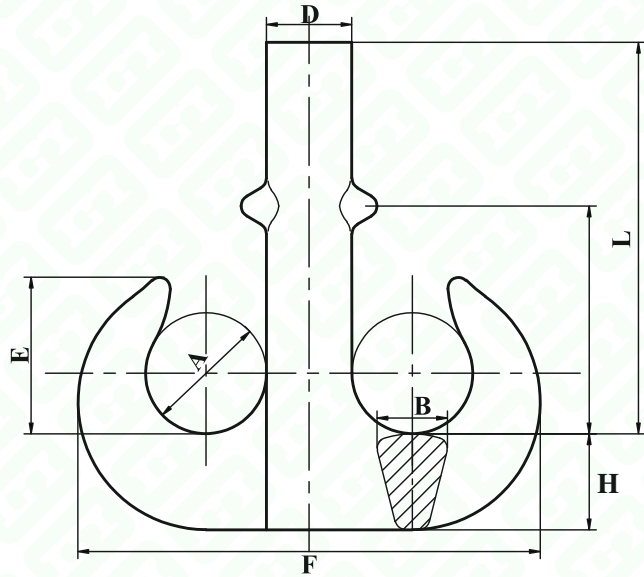

Ramshorn Hooks DIN (GM 15402)

Nr	Dimensions							Weight Kg/Pcs
	A	B	H	D	E	F	L	
8	80	67	85	67	103	337	415	25
10	90	75	95	75	116	377	450	35
12	100	85	106	85	130	421	510	49
16	112	95	118	95	146	471	580	69
20	125	106	132	106	163	531	650	97
25	140	118	150	118	182	598	715	135
32	160	132	170	132	205	672	790	193
40	180	150	190	150	230	754	885	280
50	200	170	212	170	260	842	965	388

Our products have been certified according to EC regulations, they have CE marks
Forged With Latch
Material : P=S355, S-T=42crMo4





Drive Group Table

The table below specifies the drive group as a function of hook strength class, and the lifting capacity as a function of hook number. It does not make specifications for hooks whose lifting capacity is under 100 kg or over 500,000 kg. Where such hooks are to be used in exceptional cases, the lifting capacity shall be selected in accordance with the R10 series of preferred numbers specified in DIN 323 Part 1.



STRENGTH CLASS		DRIVE GROUP 1)										STRENGTH CLASS
M	-	-	-	-	1B _m / M3	1A _m / M4	2 _m / M5	3 _m / M6	4 _m / M7	5 _m / M8	M	
P	-	-	-	1B _m / M3	1A _m / M4	2 _m / M5	3 _m / M6	4 _m / M7	5 _m / M8	-	P	
S	-	-	1B _m / M3	1A _m / M4	2 _m / M5	3 _m / M6	4 _m / M7	-	-	-	S	
T	-	1B _m / M3	1A _m / M4	2 _m / M5	3 _m / M6	4 _m / M7	-	-	-	-	T	
V	1B _m / M3	1A _m / M4	2 _m / M5	3 _m / M6	4 _m / M7	-	-	-	-	-	V	
HOOK NUMBER		LIFTING CAPACITY (kg)										HOOK NUMBER
006	320	250	200	160	125	100	-	-	-	-	006	
010	500	400	320	250	200	160	125	100	-	-	010	
012	630	500	400	320	250	200	160	125	100	-	012	
020	1000	800	630	500	400	320	250	200	160	125	020	
025	1250	1000	800	630	500	400	320	250	200	160	025	
04	2000	1600	1250	1000	800	630	500	400	320	250	04	
05	2500	2000	1600	1250	1000	800	630	500	400	320	05	
08	4000	3200	2500	2000	1600	1250	1000	800	630	500	08	
1	5000	4000	3200	2500	2000	1600	1250	1000	800	630	1	
1.6	8000	6300	5000	4000	3200	2500	2000	1600	1250	1000	1.6	
2.5	12500	10000	8000	6300	5000	4000	3200	2500	2000	1600	2.5	
4	20000	16000	12500	10000	8000	6300	5000	4000	3200	2500	4	
5	25000	20000	16000	12500	10000	8000	6300	5000	4000	3200	5	
6*	32000	25000	20000	16000	12500	10000	8000	6300	5000*	4000	6	
8	40000	32000	25000	20000	16000	12500	10000	8000	6300	5000	8	
10*	50000	40000	32000	25000	20000	16000	12500	10000	8000*	6300	10	
12*	63000	50000	40000	32000	25000	20000	16000	12500*	10000*	8000	12	
16*	80000	63000	50000	40000	32000	25000	20000	16000*	12500	10000	16	
20*	100000	80000	63000	50000	40000	32000	25000	20000*	16000	12500	20	
25	125000	100000	80000	63000	50000	40000	32000	25000	20000	16000	25	
32*	160000	125000	100000	80000	63000	50000	40000*	32000*	25000	20000	32	
40*	200000	160000	125000	100000	80000	63000	50000*	40000	32000	25000	40	
50	250000	200000	160000	125000	100000	80000	63000	50000	40000	32000	50	
63*	320000	250000	200000	160000	125000	100000	80000*	63000	50000	40000	63	
80*	400000	320000	250000	200000	160000	125000	100000*	80000	63000	50000	80	
100*	500000	400000	320000	250000	200000	160000	125000*	100000	80000	63000	100	
125*	-	500000	400000	320000	250000	200000	160000*	125000	100000	80000	125	
160*	-	-	500000	400000	320000	250000	200000*	160000	125000	100000	160	
200*	-	-	-	500000	400000	320000	250000*	200000	160000	125000	200	
250	-	-	-	-	500000	400000	320000	250000	200000	160000	250	

NOTE: Hooks used in a drive group lower than 1B_m / M3 are not included here.

*Hooks to be used on cranes such as, are used in steel works and rolling mills.

1) In accordance with subclause 4.1 of the February 1974 edition of DIN 15 020 Part 1 and AS1418.1 - 2002.

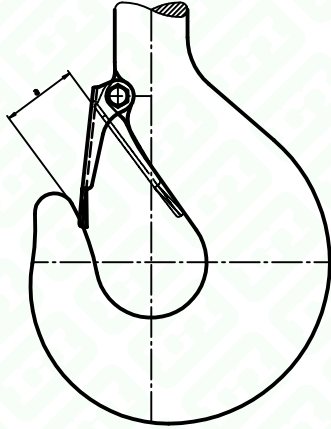

Single Hook Number	Hook aperture width a (mm)
0.5	28.00
0.8	34.00
1	34.00
1.6	40.00
2.5	41.00
4	49.00
5	55.00
6	59.00
8	69.00
10	76.00
12	84.00
16	97.00
20	110.00
25	132.00
32	137.00
40	167.00
50	188.00
63	205.00

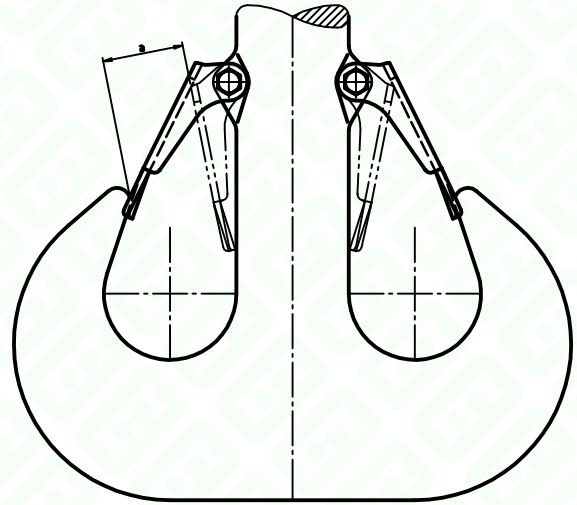

Double Hook Number	Hook aperture width a (mm)
2.5	30.00
4	31.00
5	38.00
6	48.00
8	47.00
10	57.00
12	60.00
16	63.00
20	73.00
25	87.00
32	108.00
40	112.00
50	130.00



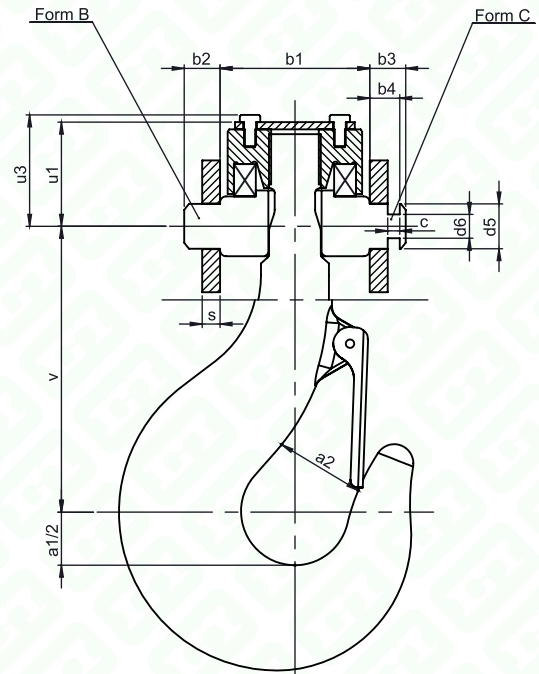

Single Hook (GM 15411)

N° HOOK	a1	b1	b2	b3	b4	c	d5	d6	s	u1	u3	v	BEARING
1	50	50	17.5	-	-	-	25	-	10	39	-	130	51.106
1.6	56	65	17.5	-	-	-	25	-	10	53	-	140	51.107
2.5	63	80	22.5	22.5	17	8	30	19	10	63.5	-	155	51.108
4	71	90	25	25	19	8	35	23	12	71	-	175	51.110
5	80	100	27.5	27.5	22	8	40	27	15	79.5	-	195	51.112
6	90	125	30	30	24	10	45	32	15	90	95	240	51.214
8	100	140	30	35	29	10	50	36	20	98	104	265	51.216
10	112	160	35	35	29	10	55	40	20	110	116	280	51.218
12	125	180	35	42.5	34	10	60	42	25	127	133	315	51.220
16	140	190	-	42.5	36	12	70	50	25	136	143	370	51.222
20	160	200	-	47.5	41	12	80	56	30	150	157	415	51.224
25	180	220	-	49	41	12	90	64	30	166	173	460	51.226
32	200	260	-	59	51	12	100	72	40	188	195	500	51.232
40	224	285	-	65	58	14	110	80	45	208	215	565	51.236
50	250	335	-	65	58	14	125	92	45	224	232	620	51.244
63	280	380	-	71	63	14	140	104	50	260	267	700	51.248
80	315	420	-	72.5	63	14	160	120	50	287	294	800	51.256
100	355	470	-	87.5	77	18	180	136	60	326	333	885	51.260
125	400	510	-	87.5	77	18	200	150	60	365	374	1000	51.268
160	450	550	-	100	87	18	220	164	70	406	416	1130	51.272
200	500	610	-	100	87	18	240	184	70	492	501	1270	51.372
250	560	700	-	110	97	18	260	200	80	552	561	1440	51.384

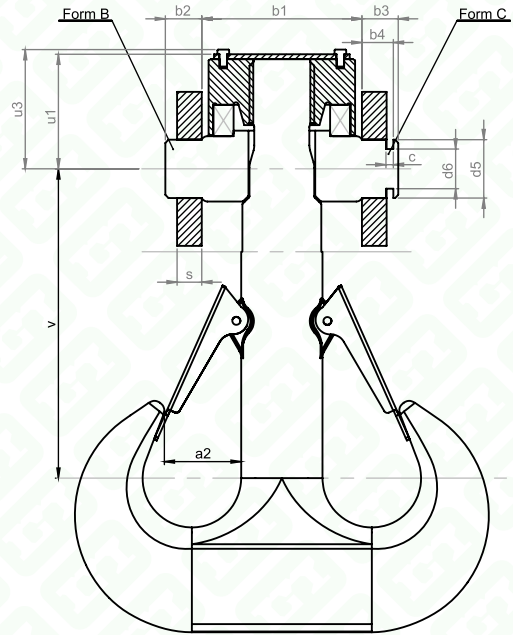

Double Hook (GM 15411)

N° HOOK	a2	b1	b2	b3	b4	c	d5	d6	s	u1	u3	v	BEARING
1	32	50	17.5	-	-	-	25	-	10	39	-	130	51.106
1.6	36	65	17.5	-	-	-	25	-	10	53	-	140	51.107
2.5	40	80	20	22.5	17	8	30	19	10	63.5	-	155	51.108
4	45	90	22.5	25	19	8	35	23	12	71	-	175	51.110
5	50	100	25	27.5	22	8	40	27	15	79.5	-	195	51.112
6	56	125	27.5	30	24	10	45	32	15	90	95	240	51.214
8	63	140	30	35	29	10	50	36	20	98	104	265	51.216
10	71	160	30	35	29	10	55	40	20	110	116	280	51.218
12	80	180	35	42.5	34	10	60	42	25	127	133	315	51.220
16	90	190	35	42.5	36	12	70	50	25	136	143	370	51.222
20	100	200	-	47.5	41	12	80	56	30	150	157	415	51.224
25	112	220	-	49	41	12	90	64	30	166	173	460	51.226
32	125	260	-	59	51	12	100	72	40	188	195	500	51.232
40	140	285	-	65	58	14	110	80	45	208	215	565	51.236
50	160	335	-	65	58	14	125	92	45	224	232	620	51.244
63	180	380	-	71	63	14	140	104	50	260	267	700	51.248
80	200	420	-	72.5	63	14	160	120	50	287	294	800	51.256
100	224	470	-	87.5	77	18	180	136	60	326	333	885	51.260
125	250	510	-	87.5	77	18	200	150	60	365	374	1000	51.268
160	280	550	-	100	87	18	220	164	70	406	416	1130	51.272
200	315	610	-	100	87	18	240	184	70	492	501	1270	51.372
250	355	700	-	110	97	18	260	200	80	552	561	1440	51.384



Hook Travers (GM 15412)

Nr	Dimensions							Weight Kg/Pcs
	B1	B2	D2	D4	D5	H1	H3	
05-1	51	94					27	0.73
1.6	68	104	25	38	27	32	30	1.05
2.5	85	132	28	43	32	43	40	2.00
4	93	145	35	60	37	47	44	3.00
5	102	158	33	69	42	52	47	3.90
6	127	189	40	79	47	57	52	6.50
8	142	210	44	89	50	63	58	8.90
10	163	235	45	99	55	72	66	13.40
12	180	268	53	110	63	86	79	19.50
16	197	285	75	120	74	98	91	26.20
20	207	302	74	131	85	97	90	29.00
25	220	318	74	140	95	109	101	38.00
32	260	378	113	160	100	115	106	55.00
40	290	425	115	185	115	135	125	85.00
50	340	475	130	225	130	150	140	125.00

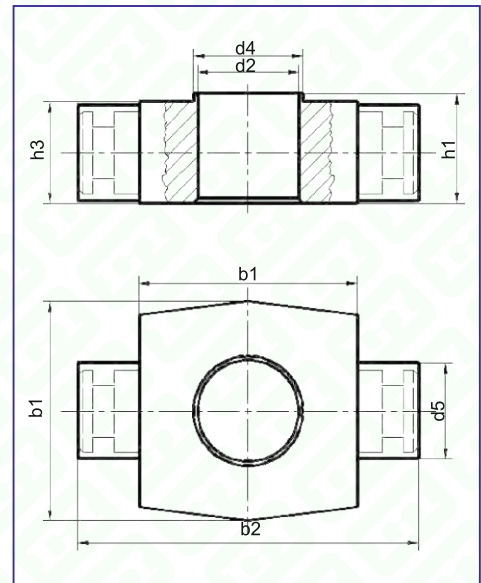

* Please contact us for other materials and for dimensions of the special products.

** All of our products are being tested according to relevant standards by using test devices which are calibrated by TSE.

If requested, all tests are done under supervision of GLIS' inspector and reported by GLIS.

Forged

Material : C 35 - C 45 42CRMO4

Safety Latch

L	15401 Nr	15402 Nr	GM 319 Nr	Eye Hook Nr	Dimensions			
					B	C	D	E
43	025		2.5 - 3.2	1.2-1.6-2.5	4	19	20	1.5
53	05		5.4	3.2-5.4	4	19	20	1.5
67	08 - 1-1.6		8	8	5	28	32	3
85	2.5 - 4		11.5 - 16	11.5	6	35	42	3
106	5			16	7	35	45	4
120	6	8		21.2	7	38	50	4
135	8-10	10-12		30	9	48	55	4
155	12	16			11	63	62	4
185	16	20			11	68	65	4
215	20	25			11	73	72	5
230	25	32			13	85	91	5
277	32-40	40			13	91	88	5
330	50	50			18	116	113	5
380	63	80			18	114	96	96

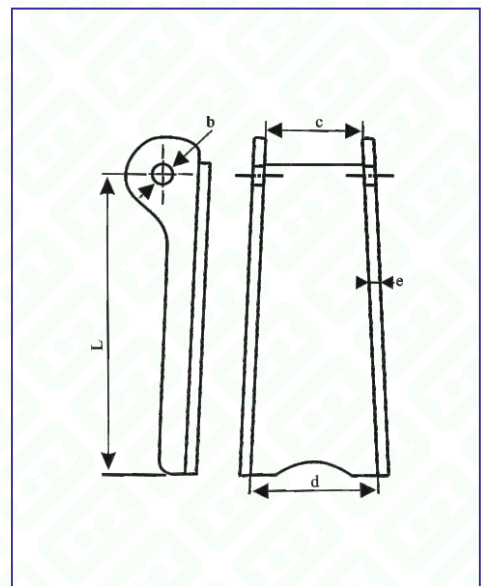

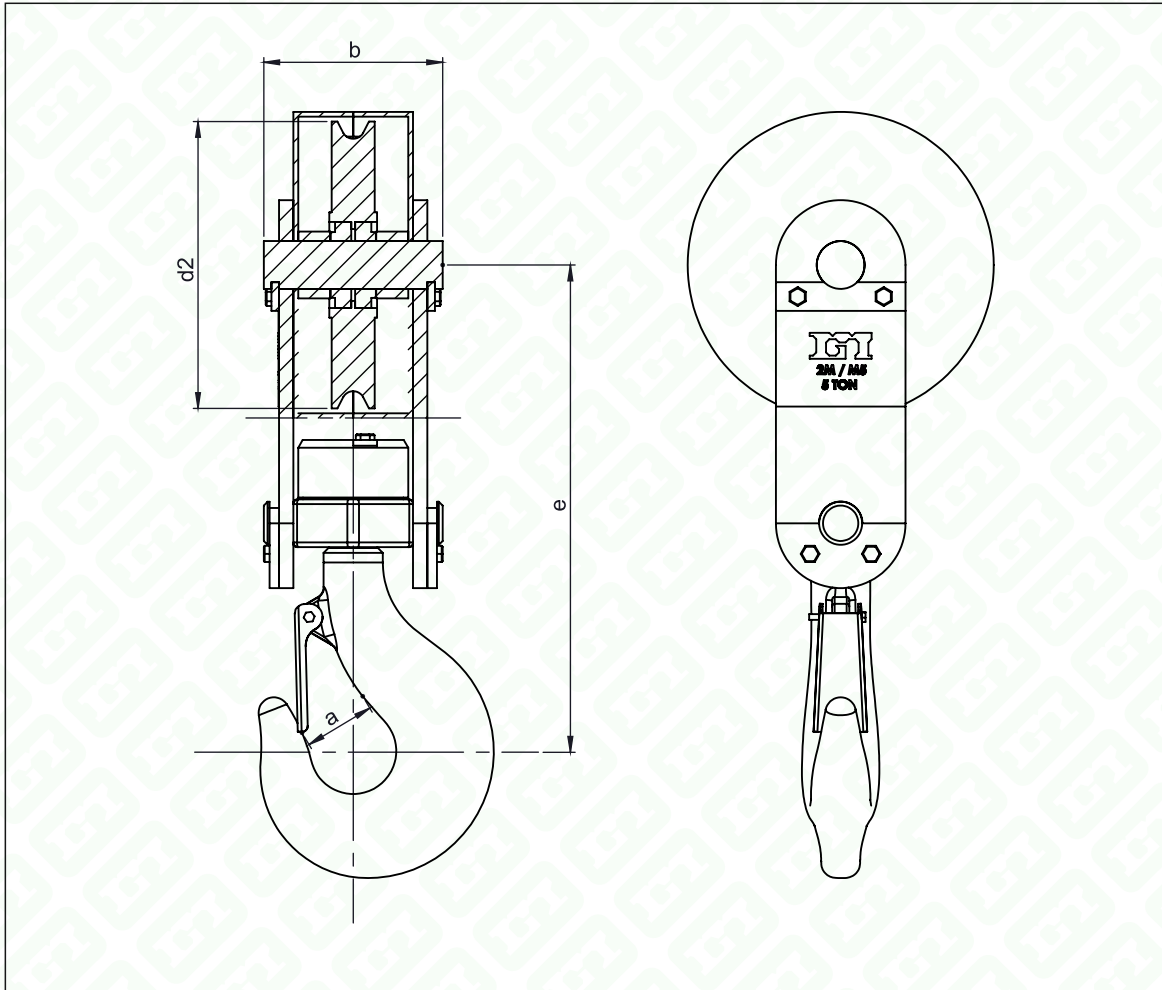

Hook Number GM 15401	Load Capacities t		Wire Rope mm	Dimensions			
	2m/M5	1 Am/M4		a	b	d2	e
Nr 1,6	3,2	4	12-14	45	100	300	380
Nr 2,5	5	6,3	16-18	50	125	350	430
Nr 4	8	10	20-22	56	140	400	485
Nr 5	10	12,5	22-24	63	155	450	535



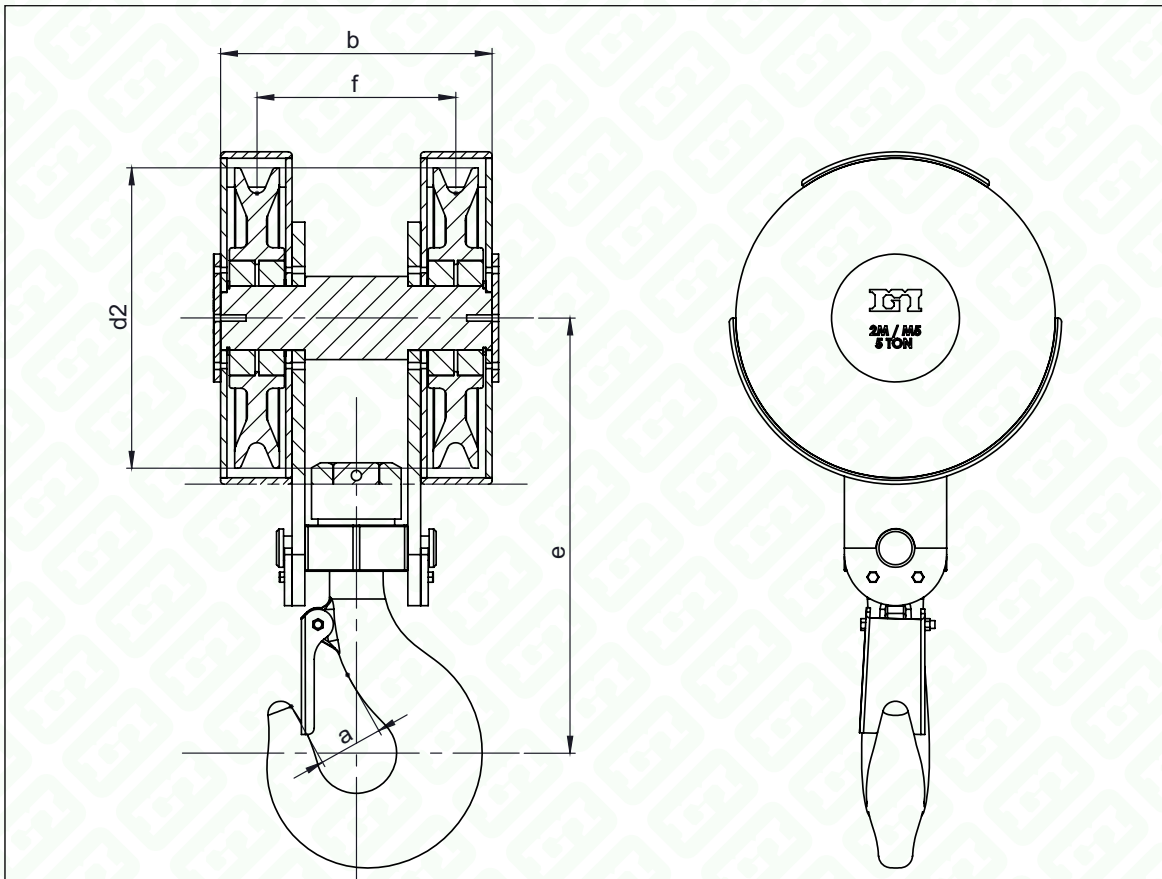

Hook Number GM 15401	Load Capacities t		Wire Rope mm	Dimensions				
	2m/M5	1 Am/M4		a	b	d2	e	f
Nr 1,6	3,2	4	10-12	45	198	220	320	135-143
Nr 2,5	5	6,3	12	50	213	250	345	171
Nr 4	8	10	14-16	56	223	350	425	190
Nr 5	10	12,5	16	63	273	350	455	220
Nr 6	12,5	16	16-18	71	298	350-400	455-550	220
Nr 8	16	20	18-20	80	313	400-450	580-605	274
Nr 10	20	25	22-24	93	343-397	450-500	630-655	274
Nr 12	25	32	24-26	107	373-427	500-550	710-735	302-329



Shank Hook GM 319

Nr	Dimensions							Weight Kg/Pcs
	A	B	C	D	F	H	H2	
1.25	32	24	50.5	18	132	17	19	0.30
1.6	36	25	57	20.5	145	18	22	0.45
2.5	37	33	67	24	162	23.5	27	0.82
3.2	42	31	90	26	181	35	32	1.10
5.4	51	39	100	32	218	30	39	2
8	64	50	125	40	272	39	47	4.10
11.5	77	62	148	51	327	46	67	7.20
16	85	68	180	59	350	56	73	10.20
22	109	87	176	68.5	460	69	77.5	17
30	127	104	224	80	587	77	93	34

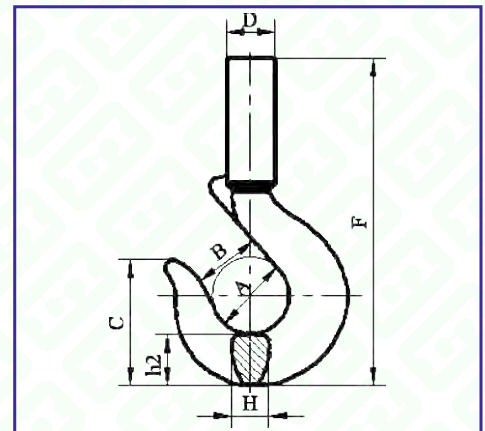

Eye Hook (GM 320)

Nr	Working Load Limit	Dimensions (mm)							Kg/Pcs	Proof Load Tons
		A	B	C	D	F	H	I		
7	1.6	35	25	43	23	85	19	23.5	0.53	3
9	2.5	38.5	27	50	28.8	93	24	28	0.82	5
10	3.2	43	32	60	31.5	103	27	33	1.38	6.6
13	5.3	51	36	63	39	136	31	41	2.2	10.8
16	8	63.5	47	85	50.5	160	45	52	4.32	16
19	11.2	77	59.5	90	62	265	49	63	7.74	22.4
23	16	84	69	83	71	320	60	72	11.84	32
26	21.2	106	85	125	86	291	65	85	20	42.2
32	30	128	115	138	90	348	85	102	30	60

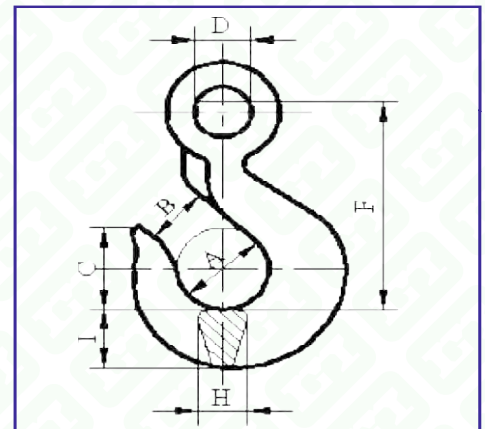

* Please contact us for other materials and for dimensions of the special products.

** Our products have been certified according to EC regulations, they have CE mark.

*** All of our products are being tested according to relevant standards by using test devices which are calibrated by TSE. If requested, all tests are done under supervision of GLIS' inspector and reported by GLIS.



GM 210



GM 2150



GM 209



GM 2130

(GM 210) Chain Shackle With Screw Pin & (GM 2150) Chain Shackle With Bolt Pin

Nominal Size (inch)	Working Load Limit	Dimensions (mm)							Kg/Pcs		Proof Load Tons
		d	D	e	E	K	S	W	Screw Pin	Safety Pin	
5/8	3.25	17	20	39	27	20.9	54	27	0.6	0.69	6.5
3/4	4.75	20	22	45	33	24.2	66	33	1	1.14	9.5
7/8	6.5	22.4	25	50	36.5	27.5	77	36.5	1.54	1.65	13
1	8.5	26	30	58	41	30.8	92	42	2.31	2.56	9
1-1/8	9.5	30	33.7	68	45	32.7	95	45	3.1	3.47	19
1-1/4	12	33	36	76	51.5	38.5	104	51.5	4.42	4.89	24
1-3/8	13.5	38	39	85	56	41.8	112	56	5.78	6.38	27
1-1/2	17	40	41	93	60	43.2	131	60	7.69	8.58	34
1-3/4	25	46	52	106	75	56.1	156	76	13.28	14.87	50
2	35	54	60	125	83	66	171	84	19.75	20.98	70
2-1/2	55	70	70	150	105	88	210	105	39.3	40.5	110
3	85	80	90	170	130	99	230	130	58.1	59	170
3-1/2	120	95	110	210	140	121	250	140	99.4	101	240
4	150	108	125	240	150	137	280	150	126.9	129	300

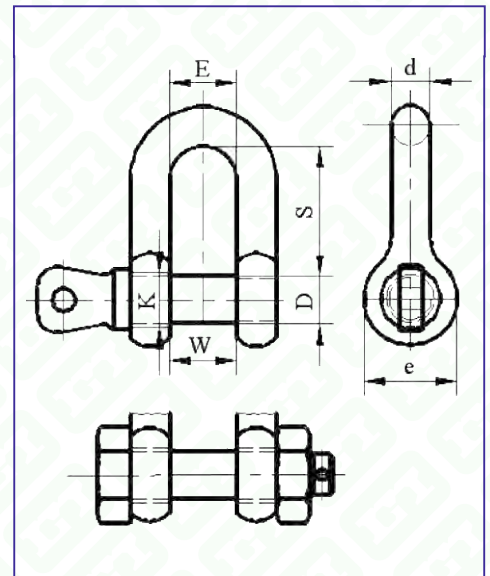

(GM 209) Anchor Shackle With Screw Pin & (GM 2130) Anchor Shackle With Bolt Pin

Nominal Size (inch)	Working Load Limit	Dimensions (mm)							Kg/Pcs		Proof Load Tons
		d	D	e	E	K	S	W	Screw Pin	Safety Pin	
5/8	3.25	17	20	39	39	20.9	59	27	0.71	0.8	6.5
3/4	4.75	20.8	21.6	47	49	23.5	70	31.5	1.14	1.29	9.5
7/8	6.5	22.4	25	53	56	26	84	35	1.72	1.81	13
1	8.5	27	30	61	67	30.8	95	42	2.45	2.74	9
1-1/8	9.5	29	32.7	67	74	35.2	111	46.5	3.49	3.88	19
1-1/4	12	33	36	74	80	38.5	121	51	4.81	5.34	24
1-3/8	13.5	37	39	82	92	41.8	139	58	6.28	6.78	27
1-1/2	17	40	41.2	90	97	44.2	152	60	8.31	9.12	34
1-3/4	25	48	52	107	127	56.1	190	76	15.2	16.33	50
2	35	54	60	122	146	66	202	84	21.47	22.52	70
2-1/2	55	70	70	150	185	88	267	105	44.8	45.9	110
3	85	80	90	170	200	95	330	130	77.5	78	170
3-1/2	120	95	110	210	230	121	360	140	131.3	132	240
4	150	108	125	240	260	137	380	150	157.8	160	300

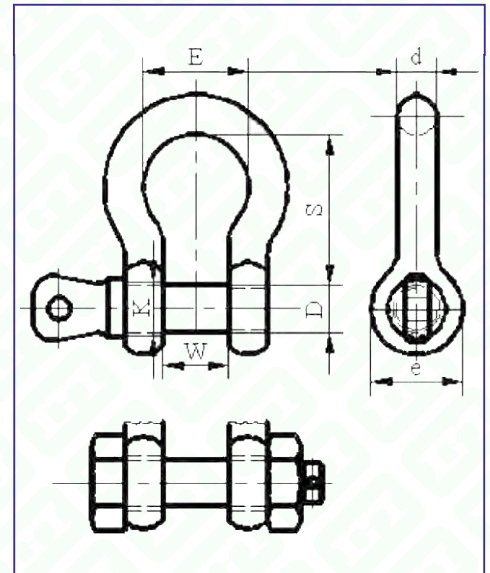

* Please contact us for other materials and for dimensions of the special products.

** Our products have been certified according to EC regulations, they have CE mark.

*** All of our products are being tested according to relevant standards by using test devices which are calibrated by TSE. If requested, all tests are done under supervision of GLIS' inspector and reported by GLIS.

Forged



Swivels (GM 322)

Nominal Size (inch)	Working Load Limit	Dimensions (mm)								Kg/Pcs	Proof Load Tons
		B	C	D	E	F	I	S	T		
5/8	2.5	63	17	41	41	20	88	37	33	1.35	5
3/4	3.2	73	21	49	50	22	90	42	31	2	6.4
7/8	5.4	81	23	53	65	25	106	51	39	3.6	10.8
1	8	92	26	60	60	33	135	64	50	6	16
1-1/4	11.5	114	34	70	79	40	157	78	62	11	23
1-3/8	16	126	36	67	97	42	175	85	68	17	32
1-5/8	22	160	42	95	120	48	225	106	98	38.50	44
2	30	165	50	91	128	55	255	110	93	54.50	60

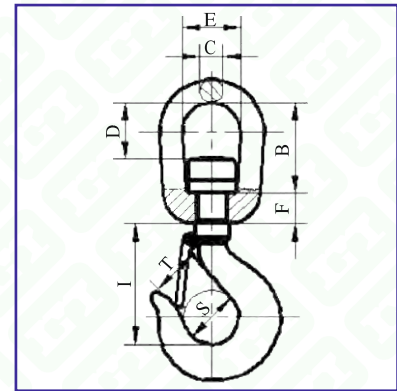

Swivels (GM 701)

Nominal Size (inch)	Working Load Limit	Dimensions (mm)					Kg/Pcs	Proof Load Tons
		B	C	D	E	F		
5/8	2.5	60	17	38	40	20	1.4	5
3/4	3.2	73	21	49	51	27	2.25	6.4
7/8	5.4	81	25	53	65	27	3.6	10.8
1	8	92	29	60	60	33	5.5	16
1-1/4	11.5	105	35	70	79	45	9.8	23
1-3/8	16	115	36	67	97	42	14.2	32
1-5/8	22	155	42	95	120	48	22.5	44
2	30	165	52	103	128	55	34.7	60

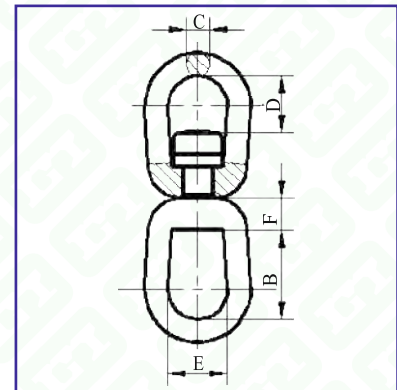

* Please contact us for other materials and for dimensions of the special products.
 ** Our products have been certified according to EC regulations, they have CE mark.
 *** All of our products are being tested according to relevant standards by using test devices which are calibrated by TSE.
 If requested, all tests are done under supervision of GLIS' inspector and reported by GLIS.



Hook + Jaw Swives (GM 702)

Nominal Size (inch)	Kanca Nr	Dimensions (mm)									Kg/Pcs	Proof Load Tons
		B1	D	E1	G	G1	Q1	R	S	T		
3	1.6	48	390	45	88	56	45	28	30	35	8	6
5	2.5	58	457	50	98	63	53	35	35	38	13	10
10	5	75	565	63	118	80	71	45	45	55	25	20
15	8	95	687	80	138	100	90	52	48	65	40	30
25	12	118	850	107	168	132	140	60	60	80	70	50
35	16	132	932	114	178	145	160	65	70	85	120	70
45	20	150	1081	125	198	160	180	85	80	105	140	90

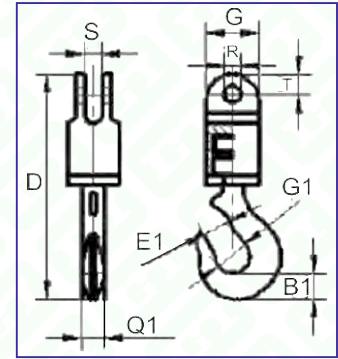

Hook + Eye Swivels (GM 703)

Nominal Size (inch)	Kanca Nr	Dimensions (mm)									Kg/Pcs	Proof Load Tons
		B1	D1	E1	G	G1	R1	S1	T1			
3	1.6	48	375	45	88	56	28	30	35	8	6	
5	2.5	58	440	50	98	63	35	35	38	14.3	10	
10	5	75	543	63	118	80	44	45	55	25	20	
15	8	95	662	80	138	100	51	50	65	40	30	
25	12	118	820	107	168	132	60	60	80	70	50	
35	16	132	897	114	178	145	70	70	85	120	70	
45	20	150	1041	125	198	160	80	80	105	140	90	

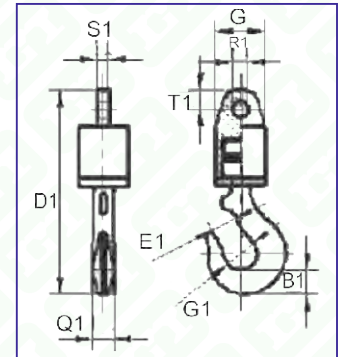

* Please contact us for other materials and for dimensions of the special products.
 ** Our products have been certified according to EC regulations, they have CE mark.
 *** All of our products are being tested according to relevant standards by using test devices which are calibrated by TSE.
 If requested, all tests are done under supervision of 'GLIS' inspector and reported by GLIS.



Bearing Swivels Eye + Eye (GM 704)

Working Load Limit	Dimensions (mm)					Kg/Pcs	Proof Load Tons
	D3	G	R1	S1	T1		
3	250	88	28	24	35	8	6
5	301	98	35	31	38	13	10
10	385	118	44	40	50	25	20
15	450	130	51	48	65	40	30
25	560	168	60	60	80	70	50
25	600	178	65	70	85	120	70
45	600	198	85	80	105	140	90

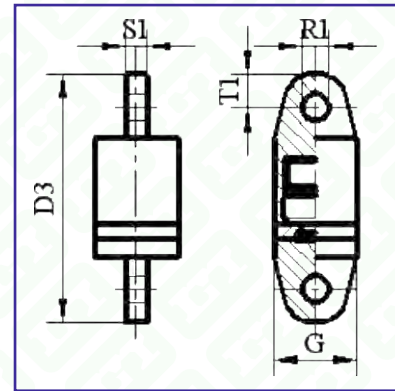

Bearing Swivels Jaws + Jaws (GM 705)

Working Load Limit	Dimensions (mm)					Kg/Pcs	Proof Load Tons
	D2	G	R	S	T		
3	285	88	28	30	35	8	6
5	335	98	35	35	38	13	10
10	427	118	44	45	50	25	20
15	500	130	51	48	65	40	30
25	620	168	60	60	80	70	50
25	670	178	65	70	85	120	70
45	785	198	85	80	105	140	90

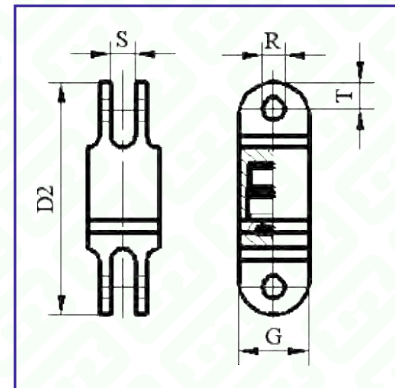

* Please contact us for other materials and for dimensions of the special products.
 ** Our products have been certified according to EC regulations, they have CE mark.
 *** All of our products are being tested according to relevant standards by using test devices which are calibrated by TSE.
 If requested, all tests are done under supervision of GLIS' inspector and reported by GLIS.



Eye - Eye Pipe Turnbuckles (GM 82004)

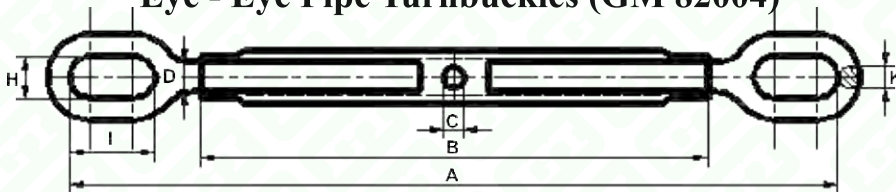

Jaws - Jaws Pipe Turnbuckles (GM 1478)

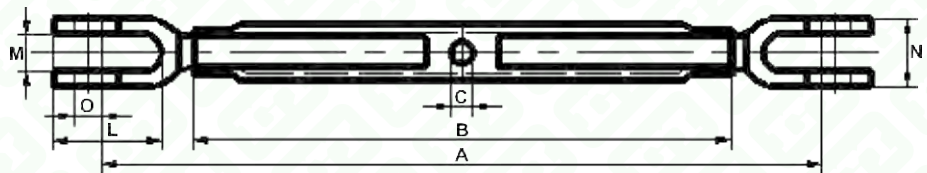

Jaws & Eye Pipe Turnbuckles

Nominal Size (DXP)	Working Load Limit	Dimensions (mm)														Proof Load Tons
		A				B	C	D	H	I	K	L	M	N	O	
		Eye		Jaw												
		Open	Closed	Open	Closed											
16X2	1.7	480	340	530	380	230	12	18	22	45	16	60	18.5	45	17	3.4
20X2.5	3	700	460	720	480	300	18.5	20	25	55	20	72	25	51	21	6
27X3	5	860	600	800	620	370	20	27	35	70	24	96	30	68	26	10
33X3.5	8	880	600	950	650	390	21	33	35	70	24	96	30	68	28	16
36.4	10	960	650	1000	700	420	22	36	40	80	28	126	45	92	32	20
42X4.5	15	1180	750	1250	880	550	24	42	50	110	32	135	53	102	38	30
48X5	20	1510	1030	1555	1035	640	27	48	60	140	42	170	60	126	44	40

* Please contact us for other materials and for dimensions of the special products.

** Our products have been certified according to EC regulations, they have CE mark.

*** All of our products are being tested according to relevant standards by using test devices which are calibrated by TSE. If requested, all tests are done under supervision of GLIS' inspector and reported by GLIS.



Forged Oblong Master Link (GM 340) - GRADE 80

Nominal Size (inch)	Working Load Limit SWL/Ton	Dimensions (mm)			Proof Load Tons	Weight Kg/Pcs
		A	B	C		
5/8	3	16	68	115	6	0.60
3/4	5	19	71	140	10	1.10
1	10	26	90	180	20	2.40
1-1/4	15	32	113	225	30	4.87
1-1/2	20	40	135	268	40	8.15
1-3/4	28	45	154	306	56	14
2	40	50	180	350	80	16
2-1/2	60	65	205	407	93	21

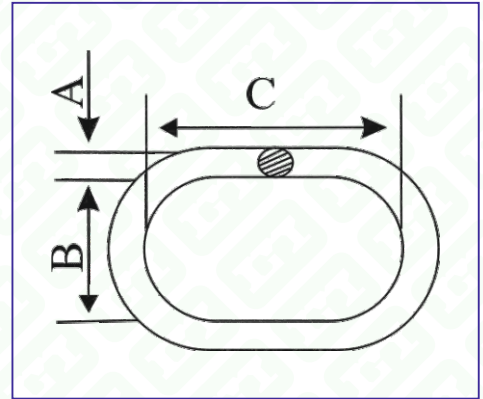

Welded Master Link Assembly (GM 314) - GRADE 80

Nominal Size (inch)	Dimensions (mm)						Proof Load Tons	Weight Kg/Pcs
	A	B	C	D	E	F		
4.75	22	70	140	15	50	120	9.5	3.00
6.3	26	90	160	18	70	140	12.6	3.8
10	28	100	177	20	80	160	20	5
15	36	120	220	26	90	180	30	9.7
20	40	140	265	32	113	225	40	18.5
25	45	150	300	32	113	225	50	21.7

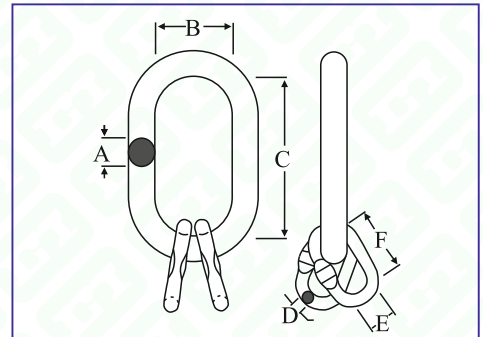



GM 11420 B



GM 11420 C



GM 11420 B



GM 11420 S

Blocks (GM 11420 B-C)

Nominal Size d2XS	Working Load Limit	Dimensions (mm)										Rope Size		Kg/ad.	Proof Load Tons
		a	b	b1	b2	b3	b4	d1	d4	e	H	Manila Rope	Wire Rope		
65X1	0,5	32	24	80	22	45	16	13	15	23	140	8	12	1,2	2
65X2	0,5	32	24	80	22	45	16	13	15	50	140			1,7	1
65X3	0,5	32	24	80	22	45	16	13	15	76	140			2,2	1
100X1	1	39	33	120	25	55	20	20	18	30	195	10	20	3,5	4
100X2	1	39	33	120	25	55	20	20	18	65	195			4,9	2
100X3	1	39	33	120	25	55	20	20	18	98	195			6,2	2
125X1	2	42	31	145	25	55	20	20	24	30	260	14	20	7	8
125X2	2	42	31	145	25	55	20	20	24	65	260			8,7	4
125X3	2	42	31	145	25	55	20	20	24	98	260			10,5	4
150X1	3	51	39	168	35	70	24	20	25	31	300	16	20	8	12
150X2	3	51	39	168	35	70	24	20	25	67	300			12	6
150X3	3	51	39	168	35	70	24	20	25	100	300			15	6
200X1	5	64	36	230	40	80	28	24	30	38	390	20	-	18	20
200X2	5	64	46	230	40	80	28	24	30	80	390			25	10
200X3	5	64	46	230	40	80	28	24	30	120	390			33	10
300X1	8	83	77	340	50	113	32	26	35	52	550	24	-	33	32
350X1	12	109	87	390	60	140	42	26	40	52	650	26	-	45	48
410X1	15	127	104	440	60	140	42	28	45	58	750	28	-	58	60

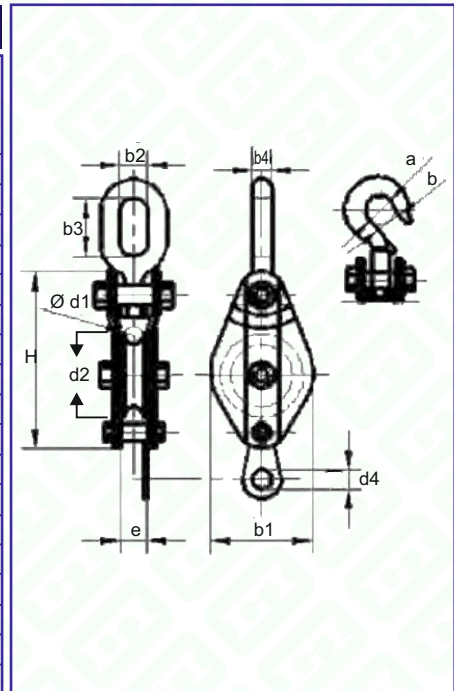

Blocks (GM 11420 S)

Nominal Size d2XS	Working Load Limit	Dimensions (mm)										Rope Size	Kg/ad.	Proof Load Tons
		a	b	b1	b2	b3	b4	d1	d4	e	H	Wire Rope		
100X1	1	39	27	120	25	55	20	20	18	30	195	10	4	2
125X1	2	42	31	145	25	55	20	20	24	30	260	14	7	4
150X1	3	51	39	168	35	70	24	20	25	31	300	16	9,6	6
200X1	6	64	46	230	40	80	28	20	30	38	390	20	20	12
250X1	10	76	62	290	50	113	32	26	35	52	450	24	25	20
300X1	15	83	77	330	50	113	32	26	35	52	550	24	33	30
350X1	20	109	87	380	60	140	42	26	40	52	650	26	45	40

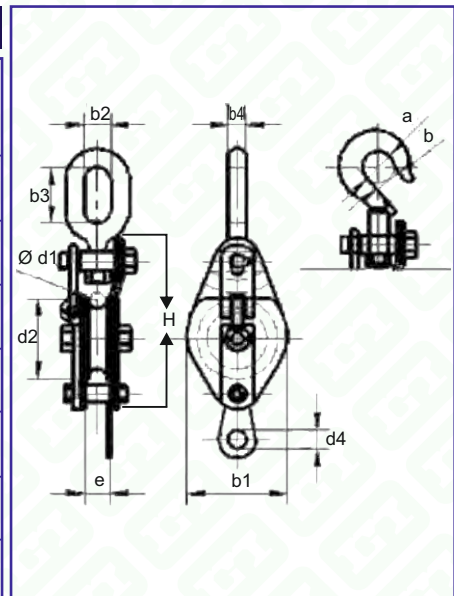

* Please contact us for other materials and for dimensions of the special products.
 ** Our products have been certified according to EC regulations, they have CE mark.
 *** All of our products are being tested according to relevant standards by using test devices which are calibrated by TSE.
 If requested, all tests are done under supervision of GLIS' inspector and reported by GLIS.

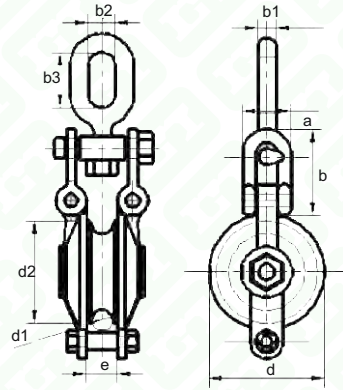

Japon Type Blocks (GM 11422)

Nominal Size d2	Working Load Limit	Dimensions (mm)									Weight Kg/Pcs
		a	b	b1	b2	b3	d	d1	d2	e	
150	5	70,5	120	28	40	80	170	30	150	40	18

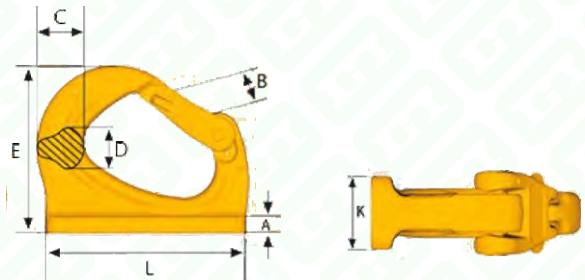

Weld - On Hook (GM 474)

Nominal Size mm	Working Load Limit	Dimensions (mm)							Weight Kg/Pcs
		A	B	C	D	E	K	L	
37X130	3	10	32	28	26	110	37	130	1.40
40X135	5	12	34	32	23	120	40	135	2.85
50X170	8	13	50	51	41	143	50	170	3.50
55X220	10	14	53	58	43	170	55	220	6.35

* Please contact us for other materials and for dimensions of the special products.
 ** Our products have been certified according to EC regulations, they have CE mark.
 *** All of our products are being tested according to relevant standards by using test devices which are calibrated by TSE.
 If requested, all tests are done under supervision of GLIS' inspector and reported by GLIS.



Eye Bolts (GM 580)

Nominal Size	Working Load Limit		Dimensions (mm)							Kg/ad	Proof Load Tons
	Tek Uyg.	İkili Uyg.	B	d	dg	E	F	G	H		
M8	0.14	0.20	20	8	6	20	8	20	13	0,06	0,32
M10	0.23	0.34	24	10	8	24	10	23	16	0,103	0,5
M12	0.34	0.48	30	12	9.4	30	11	28	20	0,177	0,8
M16	0.70	1	34	16	12.8	34	14	36	26	0,28	1,25
M20	1.2	1.7	40	20	16.38	39	16	37	30	0,424	2
M24	1.8	2.58	48	24	20.17	50	20	50	36	0,834	3,2
M30	4	5.6	65	30	25.56	60	26	60	42	1,66	5
M36	6.3	8.82	75	36	30.94	70	28	67	51	2,65	8
M42	8	11.12	84	42	36.33	80	34	90	61	4,03	12,5
M48	10	14	95	48	41.32	93	42	100	70	6,32	16
M56	16	22.4	112	56	48.32	110	48	119	76	8,8	20
M64	20	28	123	64	56.49	123	54	130	85	23,3	32
M72	25	35	123	72	64.49	123	54	130	98	-	40
M80	32	44.8	160	80	72.49	160	65	165	112	-	50
M90	40	56	180	90	82.64	180	71	180	125	-	63
M100	50	70	200	100	92.64	180	80	195	140	-	80

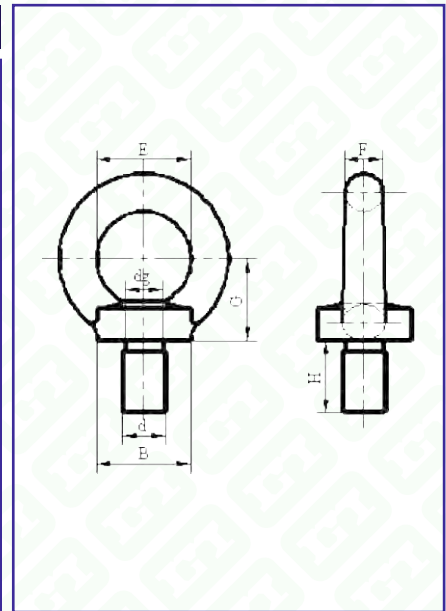

Eye Nuts (GM 582)

Nominal Size	Working Load Limit		Dimensions (mm)							(Kg/ad)	Proof Load Tons	
	Tek Uyg.	İkili Uyg.	B	d	E	F	G	H	K			M
M8	0.14	0.20	20	8	20	8	20	36	8,5	10	0,05	0,32
M10	0.23	0.34	25	10	24	10	25	45	10	12	0,09	0,5
M12	0.34	0.48	30	12	30	12	26	53	11	14	0,16	0,8
M16	0.70	1	35	16	34	14	31	62	13	16	0,24	1,25
M20	1.2	1.7	40	20	38	16	39	71	16	19	0,36	2
M24	1.8	2.58	50	24	48	20	48	90	22	24	0,72	3,2
M30	4	5.6	65	30	60	26	59	112	28	28	1,32	5
M36	6.3	8.82	75	36	70	28	69	128	33	34	2,08	8
M42	8	11.12	85	42	80	34	87	155	35	45	3,11	12,5
M48	10	14	95	48	93	42	96	188	48	46	5,02	16
M56	16	22.4	110	56	110	48	184	187	45	50	-	20
M64	20	28	120	64	123	54	206	240	59	59	-	32
M72	25	35	150	72	123	54	260	240	59	72	-	40
M80	32	44.8	170	80	160	65	296	308	72	80	-	50
M100	50	70	190	100	180	80	360	330	80	88	-	80

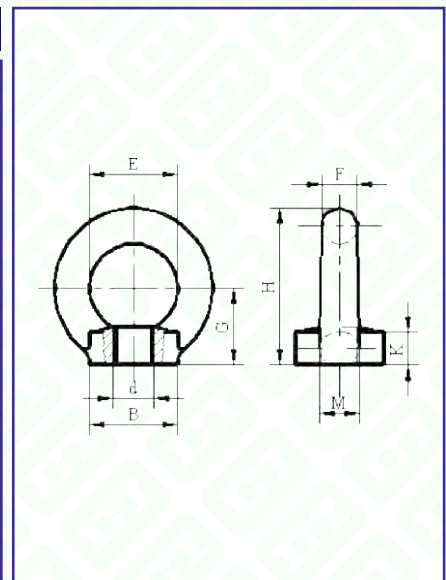

* Please contact us for other materials and for dimensions of the special products.
 ** Our products have been certified according to EC regulations, they have CE mark.
 *** All of our products are being tested according to relevant standards by using test devices which are calibrated by TSE.
 If requested, all tests are done under supervision of GLIS' inspector and reported by GLIS.
 Forged



Open Wedge Socket (GM 422)

Nominal Size (Inch)	Wire Rope Dia (mm)	Dimensions (mm)								Working Load Limit
		A	C	D	E	F	L	U	V	
3/8	9-10	155	19	20,5	60	14	47	36	13	2
1/2	11-13	162	24	25,5	78	19	60	50	17	3,2
5/8	14-16	190	31	30,5	92	24	70	64	23	5
3/4	18-19	224	37	36	114	27	81	70	23	6,3
7/8	20-22	255	45	42	131	30	95	80	26	8
1	26	270	45	50	134	33	105	83	27,5	12,6
1-1/8	28	358	46	55	156	37	110	95	33	16
1-1/4	32	403	63,6	64	180	47	146	110	44	20

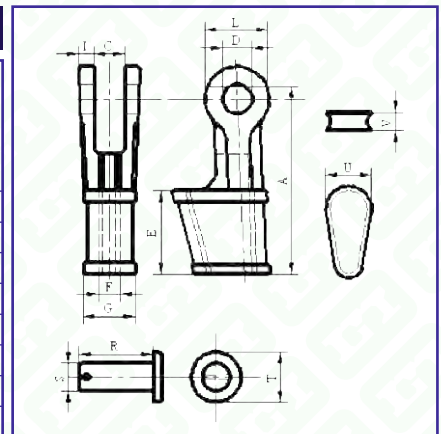

* Please contact us for other materials and for dimensions of the special products.
 ** Our products have been certified according to EC regulations, they have CE mark.
 *** All of our products are being tested according to relevant standards by using test devices which are calibrated by TSE.
 If requested, all tests are done under supervision of GLIS' inspector and reported by GLIS.

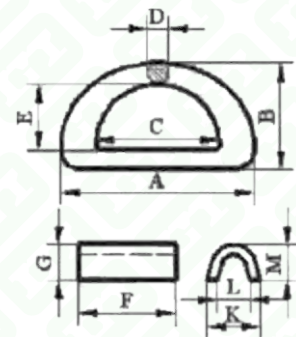

Lashing Rings (GM 740)

Nominal Size mm	Working Load Limit	Dimensions (mm)								Weight Kg/Pcs
		A	B	C	D	E	F	G	K	
19	4	134	93	101	19	55	70	30	45	1.21
23	8,75	200	120	130	23	76	100	40	61	2.42
28	13	237	148	150	28	90	120	43	70	4.43

* Please contact us for other materials and for dimensions of the special products.
 ** Our products have been certified according to EC regulations, they have CE mark.
 *** All of our products are being tested according to relevant standards by using test devices which are calibrated by TSE.
 If requested, all tests are done under supervision of GLIS' inspector and reported by GLIS.
 Forged





Horizontal Clamps (GM 1522)

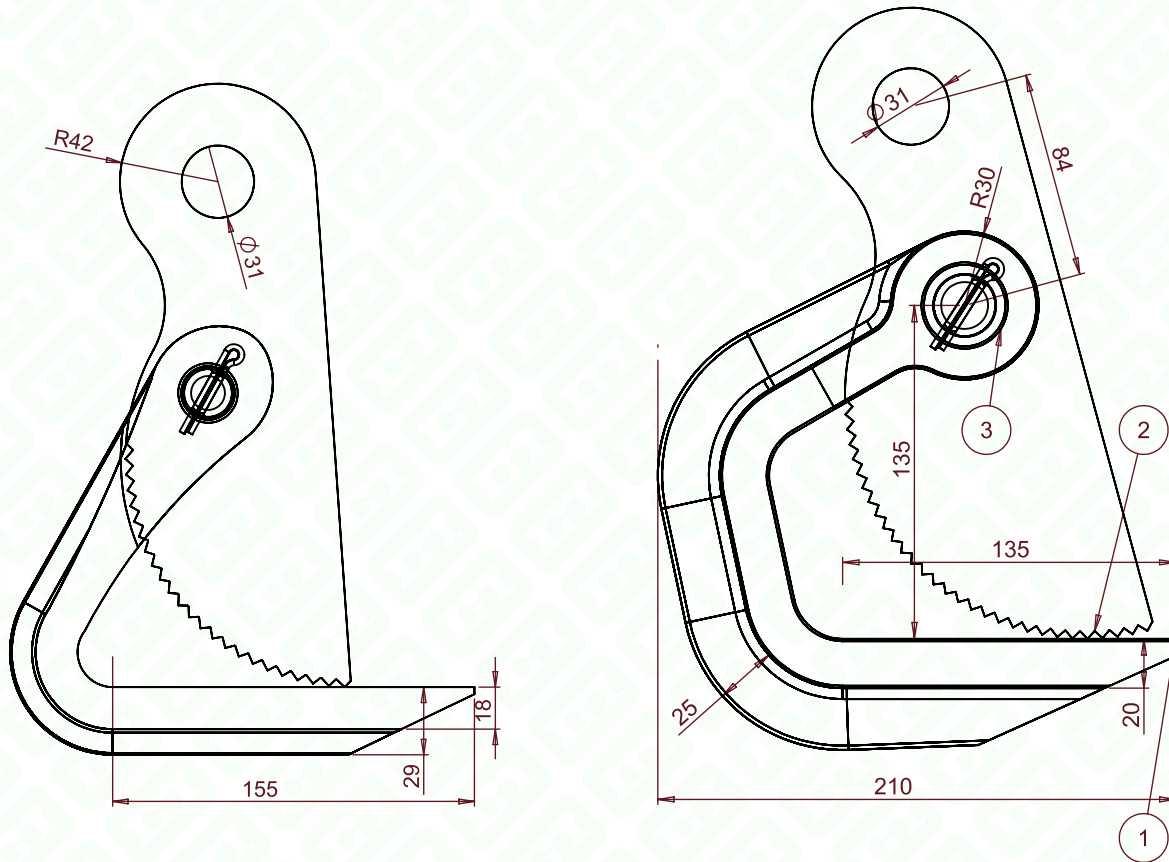

2.5 TONS 0-60 mm

5 TONS 0-65 mm

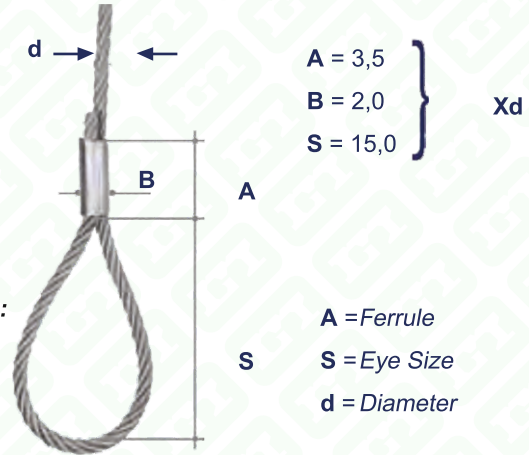

EN 13414-1

Working load limits for slings using "Fibre Cored" rope of classes: 6x19, 6x36, 8x36 Sapan Standardı: DIN 3088 FORM P, PK, EP

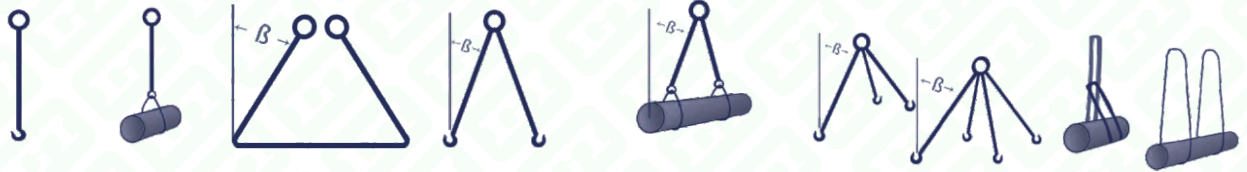

Wire Diameter	Slings with 1 Leg	Choker Hitch	Basket Sling		Slings with 2 Legs		Choker Hitch with 2 legs		Slings with 3-4 Legs		Endless Sling	
Açı Angle			0° - 45° 45° - 60°		0° - 45° 45° - 60°		0° - 45° 45° - 60°		0° - 45° 45° - 60°			
Bacak Faktörü Leg Factor	1,0	0,8	1,4	1,0	1,4	1,0	1,2	0,8	2,1	1,5	2x2	1,6

Halat Çapı

kg

8	700	560	980	700	980	700	840	560	1500	1050	2800	1100
10	1050	840	1470	1050	1470	1050	1260	840	2250	1600	4200	1700
12	1550	1240	2170	1550	2170	1550	1860	1240	3300	2300	6200	2500
13	1800	1440	2520	1800	2520	1800	2160	1440	3850	2700	7200	2900
14	2120	1700	2970	2120	2970	2120	2550	1700	4350	3150	8480	3300
16	2700	2160	3780	2700	3780	2700	3240	2160	5650	4200	10800	4350
18	3400	2720	4760	3400	4760	3400	4100	2720	7200	5200	13600	5650
20	4350	3480	6100	4350	6100	4350	5200	3480	9000	6500	17400	6900
22	5200	4160	7280	5200	7280	5200	6240	4160	11000	7800	20800	8400
24	6300	5040	8820	630	8820	6300	7560	5040	13500	9400	25200	10000
26	7200	5760	10080	7200	10080	7200	8640	5760	15000	11000	28800	11800
28	8400	6720	11760	8400	11760	8400	10080	6720	18000	12500	33600	13500
32	11000	8800	15400	11000	15400	11000	13200	8800	23500	16500	44000	18000
36	14000	11200	19600	14000	19600	14000	16800	11200	29000	21000	56000	22500
40	17000	13600	23800	17000	23800	17000	20400	13600	36000	26000	68000	28000
44	21000	16800	29400	21000	29400	21000	25200	16800	44000	31500	84000	33500
48	25000	20000	35000	25000	35000	25000	30000	20000	52000	37000	100000	40000
52	29000	23200	40600	29000	40600	29000	34800	23200	62000	44000	116000	47000
56	33500	26800	46900	33500	46900	33500	40200	26800	71000	50000	134000	54000
60	39000	31200	54600	39000	54600	39000	46800	31200	81000	58000	156000	63000





EN 13414-1

Working load limits for slings using "I.W.R.C" rope of classes:
6x19, 6x36, 8x36 Sapan Standardı: DIN 3088 FORM P, PK, EP

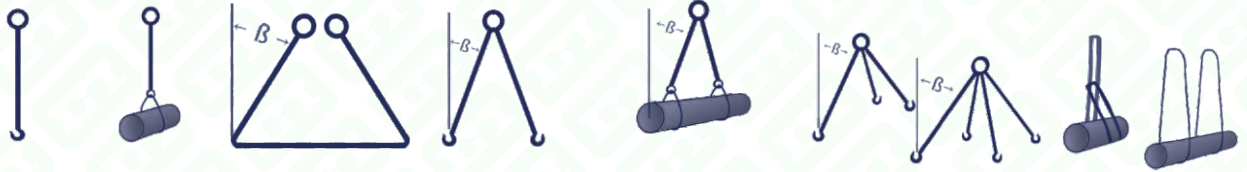

Halat Çapı Wire Diameter	Tek Bacak Slings with 1 Leg	Boğdurma Choker Hitch	Sepet Sapan Basket Sling		2 Bacaklı Slings with 2 Legs		Boğdurma 2 Bacaklı Choker Hitch with 2 legs		3 - 4 Bacaklı Slings with 3-4 Legs		Sonsuz Sapan Endless Sling	
Açı Angle			0° - 45° 45° - 60°		0° - 45° 45° - 60°		0° - 45° 45° - 60°		0° - 45° 45° - 60°			
Bacak Faktörü Leg Factor	1.0	0,8	1,4	1,0	1,4	1,0	1,2	0,8	2,1	1,5	2x2	1,6

Halat Çapı

kg

8	750	600	1050	750	1050	750	900	600	1550	1100	3000	1200
10	1150	920	1600	1150	1600	1150	1380	920	2400	1700	4600	1350
12	1700	1360	2300	1700	2300	1700	2040	1360	3550	2500	6800	2700
13	2000	1600	2800	2000	2800	2000	2400	1600	4150	3000	8000	3150
14	2250	1800	3150	2250	3150	2250	2700	1800	4800	3400	9000	3700
16	3000	2400	4200	3000	4200	3000	3600	2400	6300	4500	12000	4800
18	3700	2960	5200	3700	5200	3700	4440	2960	7800	5650	14800	6000
20	4600	3680	6500	4600	6500	4600	5520	3680	9800	6900	18400	7350
22	5650	4520	7800	5650	7800	5650	6780	4520	11800	8400	22600	9000
24	6700	5360	9400	6700	9400	6700	8000	5360	14000	10000	26800	10600
26	7800	6240	11000	7800	11000	7800	9360	6240	16400	11500	31200	12500
28	9000	7200	12600	9000	12600	9000	10800	7200	19000	13500	36000	14500
32	11800	9440	16500	11800	16500	11800	14160	9440	25000	17500	47200	19000
36	15000	12000	21000	15000	21000	15000	18000	12000	31500	22500	60000	23500
40	18500	14800	26000	18500	26000	18500	22200	14800	39000	28000	74000	30000
44	22500	18000	31500	22500	31500	22500	27000	18000	47000	33500	90000	36000
48	26000	20800	37000	26000	37000	26000	31200	20800	55000	40000	104000	42000
52	31500	25200	44000	31500	44000	31500	37800	25200	66000	47000	126000	50000
56	36000	28800	50000	36000	50000	36000	43200	28800	76000	54000	144000	58000
60	42000	33600	58000	42000	58000	42000	50400	33600	88000	63000	168000	67000



One Leg Slings



GMS1-1



GMS1-2



GMS1-3



GMS1-4



GMS1-5

Two Leg Slings



GMS2-1



GMS2-2



GMS2-3



GMS2-4

Three Leg Slings



GMS3-1



GMS3-2



GMS3-3



GMS3-4

Four Leg Slings



GMS4-1



GMS4-2



GMS4-3



GMS4-4

Overview of Rope Terminations and Loss of MBL caused by Rope Termination



90% crimped loop.
> %80 EN 13414-3



90% clamp thread.

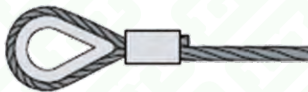

90% pressed thimble.
> %80 EN 13414-3



90% clamp head with eye.



> 80% loop/thimble with rope camps according to EN 13411-5.
Not to be uses for rope slings!



90% clamp head with clevis.



%90 sliced loop. Loops must be secured against untwisting.
> %80 EN 13414-2



> %80 rope lock with wedge.
DIN 15315



%90 Spliced thimble. loops must be secured against untwisting.
> %80 EN 13414-2



100% cast head with clevis.
EN 13414-4

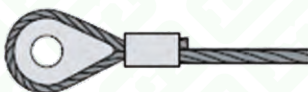

90% pressed solid thimble.
> %80 EN 13414-3



100% cast head with eye.
EN 13411-4



Working Load Limits (WLL) in tons

GRADE 100



CHAIN SLINGS	1 LEGS		2 LEGS		3 and 4 LEGS		ENDLESS	BASKET SLING				CHOKE SLING					
	ANGLE β	COEFFICIENT	Ø CHAIN	Ø 6	Ø 8	Ø 10		Ø 13	Ø 16	Ø 20	Ø 22	Ø 26	Ø 32	SINGLE		DOUBLE	
														0-45°	45-60°	0-45°	45-60°
GRADE 100	0	1	1.12	1.4	1.4	1.4	2.0	2.5	3.0	3.5	4.0	4.5	5.0	5.3	5.8	6.3	6.8
GRADE 80	1	1.4	1.60	1.96	2.35	2.94	3.2	4.0	4.8	5.6	6.4	7.2	8.0	8.8	9.6	10.4	11.2
GRADE 80	2.0	2.8	3.15	3.94	4.73	5.91	6.3	7.5	9.18	11.13	13.91	16.0	19.4	23.32	28.13	33.92	40.0
GRADE 80	2.5	3.5	4.25	5.51	6.62	8.27	8.48	10.6	13.91	17.5	22.5	27.5	34.65	44.52	55.65	68.0	82.0
GRADE 80	3.15	4.25	5.04	6.62	8.27	10.4	12.8	16.0	21.0	26.25	32.81	40.0	50.4	63.0	78.0	96.0	116.0
GRADE 80	4.0	5.51	6.3	8.27	10.4	13.13	16.0	20.0	25.5	31.5	39.38	48.0	60.0	75.0	93.0	114.0	138.0
GRADE 80	5.3	7.50	8.8	11.2	14.0	17.5	21.6	26.4	33.0	40.5	50.0	61.2	75.6	93.6	115.2	141.6	172.8
GRADE 80	6.7	9.18	11.2	14.0	17.5	22.5	28.0	34.4	42.8	52.5	64.0	78.0	96.0	117.6	144.0	176.4	216.0
GRADE 80	8.0	11.2	14.0	18.0	22.5	28.0	34.4	42.8	52.5	64.0	78.0	96.0	117.6	144.0	176.4	216.0	264.0
GRADE 80	10.0	14.0	18.0	24.0	30.0	37.5	46.0	56.0	68.0	84.0	102.0	124.0	151.2	184.8	225.6	276.0	336.0
GRADE 80	12.5	17.5	22.5	28.8	36.0	45.0	55.2	67.2	81.6	99.6	120.0	144.0	172.8	213.6	266.4	328.8	400.8
GRADE 100	16.0	21.88	28.0	36.0	45.0	56.25	68.0	82.4	100.0	122.5	150.0	182.5	221.25	271.5	334.5	411.75	500.25
GRADE 100	19.4	26.25	33.75	42.75	52.5	64.5	78.0	94.0	114.0	139.5	171.0	207.75	254.25	312.75	384.75	471.75	578.25
GRADE 100	21.2	30	38.4	48.0	59.25	72.0	87.2	105.6	128.0	156.0	192.0	232.8	285.6	351.6	432.0	528.0	645.6
GRADE 100	26.5	37.1	47.25	59.25	73.5	89.25	108.0	131.2	159.0	196.5	243.0	298.5	367.5	450.0	552.0	672.0	816.0
GRADE 100	31.5	45	57.0	71.25	87.75	106.5	128.0	155.2	188.0	230.0	282.0	345.0	420.0	516.0	624.0	756.0	912.0

GRADE 80



TEMPERATURE OF USE

GRADE 80 Accessories and chain			
Temperature	-40° to +200°C	200° to 300°C	300° to 400°C
WLL reduction	0	-10%	-25%
			> 400°C
			Forbidden
GRADE 100 Accessories			
Temperature	-40° to +200°C	200° to 300°C	300° to 380°C
WLL reduction	0	-10%	-25%
			> 380°C
			Forbidden
GRADE 100 chain			
Temperature	-40° to +200°C		> 200°C
WLL reduction			Forbidden

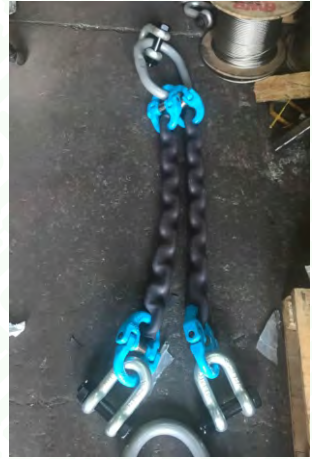



Chain According to EN 818-2

mm	inch	Dimensions (mm)					Weight Poids Gewicht Kg/m	W.L.L./Kg		f min
		Chain	Tolerance	P	Tolerance	Li min		Le max	GRADE 80	
6	1/4	± 0.24	18	± 0.5	7.8	22.2	0.8	1120	1400	4.8
8	5/16	± 0.32	24	± 0.7	10.4	29.6	1.4	2000	2500	6.4
10	3/8	± 0.40	30	± 0.9	13	37	2.2	3150	4000	8
13	1/2	± 0.52	39	± 1.2	16.9	48.1	3.8	5300	6700	10
16	5/5	± 0.64	48	± 1.4	20.8	59.2	5.7	8000	10000	13
20	3/4	± 1.00	60	± 1.8	26	74	9	12500	16000	16
22	7/8	± 1.10	66	± 2.0	28.6	81.4	10.9	15000	19000	18
26	1	± 1.30	78	± 2.3	33.8	96.2	15.2	21200	26500	21
32	1 1/4	± 1.60	96	± 2.9	41.6	118	23	31500		26

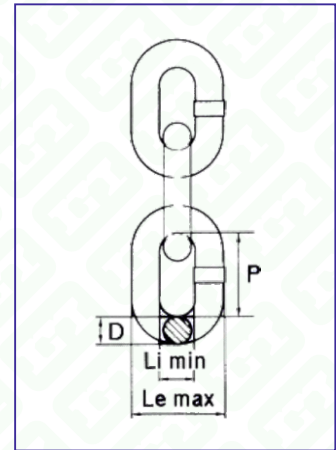

Clevis Sling Hook With Latch

mm	inch	Dimensions (mm)								Kg/Pcs	W.LL/Kg.	
		Chain	A	A1	B	C	G	H	P		R	GRADE 80
6	1/4	25	19	6.7	8.5	14.5	20	7	73	0.24	1120	1400
7-8	9/32-5/16	29.5	24.5	8.7	9.8	19	27	9	86.3	0.53	2000	2500
10	3/8	35.7	29	12.2	13.5	23.5	33	13	105	0.95	3150	4000
13	1/2	43.5	35	15.3	17	28.5	40	16	128.5	1.67	5300	6700
16	5/8	56	45	18	22	37	48	20	155	3.00	8000	10000
20	3/4	61	53	23	26	51	52	24	183	5.70	12500	16000
22	7/8	72	62	24.5	29	50	62	27	213	8.80	15000	19000
26	1	77	73	30	34	60	75	30	230	13.5	21200	26500

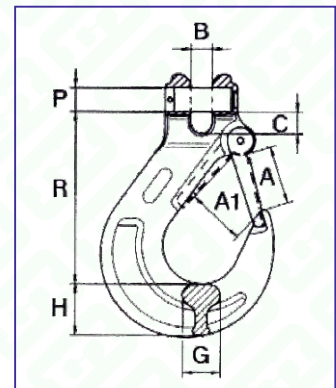

Self Locking Clevis Hook

mm	inch	Dimensions (mm)								Kg/Pcs	W.LL/Kg.	
		Chain	A	B	C	G	H	R	T		PxL	GRADE 80
6	1/4	28	7	8	16	21	94	35	7.5x17.5	0.496	1120	1400
7-8	9/32-5/16	34	9	10	20	26	123	43	9x22.5	0.934	2000	2500
10	3/8	45	12	14	25	30	143	56	13x31.5	1.580	3150	4000
13	1/2	51	15	17	35	40	180	69	16x42	3.200	5300	6700
16	5/8	60	19	19	36	50	215	80	21x51.5	5.950	8000	10000
20	3/4	70	23	26	60	67	253	90	24x73	9.800	12500	16000
22	7/8	80	26	32	62	70	287	100	26x72	14.400	15000	19000

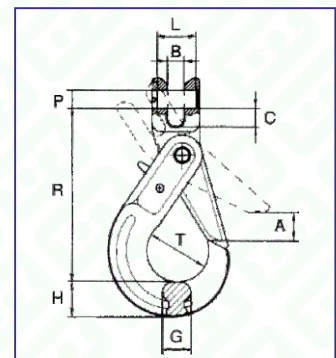



Connection Link

mm	inch	Dimensions (mm)						Kg/Pcs	W.L.L./Kg	
		Chain	A	C	O	R	P		S	GRADE 80
6	1/4	14	18	18	45	8	7.5	0.07	1120	1400
8	5/16	19	25.5	23.5	62	11.5	10	0.20	2000	2500
10	3/8	23.8	30	27.5	72	12.6	12.6	0.35	3150	4000
13	1/2	28	36	33.3	87.3	19	16.7	0.74	5300	6700
16	5/8	34.3	40.5	39.5	105	20.6	20.6	1.16	8000	10000
20	3/4	42	46	46	113	29	25	2.50	12500	16000
22	7/8	49	55	58	133	30	28	3.10	15000	19000
26	1	57	85	70	192	40	30	6.80	21200	26500
32	1 1/4	80	84.5	94.1	206	47	35	11.5	31500	40000

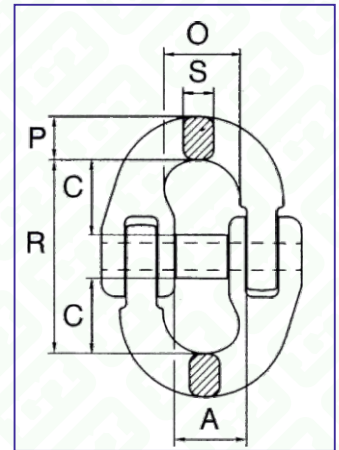





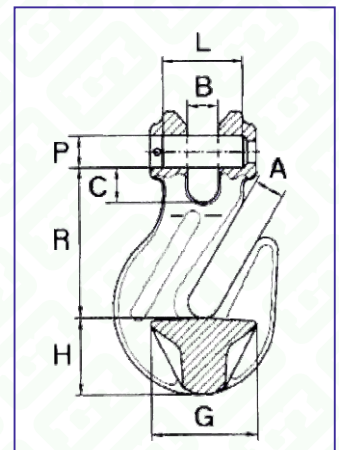

Shortening Clutch With Safety

mm	inch	Dimensions (mm)						Kg/Pcs	W.L.L./Kg	
		Chain	A	B	C	G	H		R	GRADE 80
6	1/4	8	8	8.8	22	22	51.5	0.20	1120	1400
7-8	9/32-5/16	10	9	10	30	24	50	0.27	2000	2500
10	3/8	13	13	14	44	31	72	0.75	3150	4000
13	1/2	17	17	17	53	38	88	1.35	5300	6700
16	5/8	20	21	20	64	60	111	2.8	8000	10000
20	3/4	24	24	24	85	65	130	4.8	12500	16000
22	7/8	26	26	26	87	68	139	5.65	15000	19000
26	1	30.5	30	35	100	90	190.5	13.5	21200	26500





7/1 FACTOR

Polyester Webbing Sling Ebdless Webbing Sling according to prEN 1492. parts 1 and 2.									
Colourcoded Working Load Limit	Width	Straight	Choker	Basket	90°	2 Legs		3 and 4 Legs	
						0-45°	46-60°	0-45°	46-60°
WLL 1T	40	1.0	0.8	2.0	1.4	1.4	1.0	2.1	1.5
WLL 2 T	60	2.0	1.6	4.0	2.8	2.8	2.0	4.2	3.0
WLL 3T	75	3.0	2.4	6.0	4.2	4.2	3.0	6.3	4.5
WLL 4T	100	4.0	3.2	8.0	5.6	5.6	4.0	8.4	6.0
WLL 5T	125	5.0	4.0	10.0	7.0	7.0	5.0	10.5	7.5
WLL 6T	150	6.0	4.8	12.0	8.4	8.4	6.0	12.6	9.0
WLL 8T	200	8.0	6.4	15.0	11.2	11.2	8.0	16.8	12.0
WLL 10 T	250	10.0	8.0	20.0	14.0	14.0	10.0	21.0	15.0

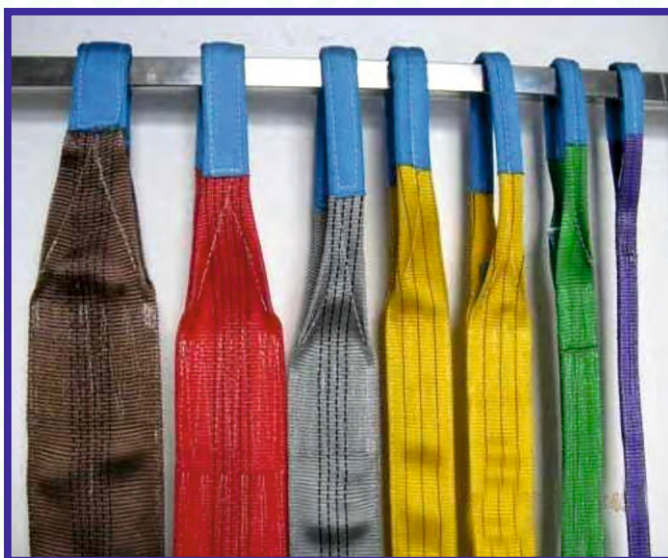



Güneş Makina
Sanayi ve Tic. Ltd. Şti



Muayene Sertifikası

TS EN 10 204 - 3.1

Inspection Test Certificate

İmalatçı Beyanı 2006/42/EC

Sertifika No
(certificate no):

08160103 1-30

Manufacture's Declaration 2006/42/EC

Tarih
(Date)

12.08.2016

İmalatçının Adı ve Adresi
Name & adress manufacturer

GÜNEŞ MAKİNA SANAYİ VE TİC. LTD.ŞTİ.
DES Sanayi Sitesi 106 Sok. B13 No.4
Y.Dudullu, İSTANBUL/TÜRKİYE

Sipariş No
(order no)

Müşterinin Adı ve Adresi
Name & adress client

ŞENOL MAKİNA

Firmamız imalatı olan kanca ve kanca traversleri TÜV-AUSTRIA tarafından CE belgelidir.
İlgili belge numarası 15-PS-0121-TAT-15-MAD-0313

Kanca Tipi Type of hook	Saplı Mandallı Basit Kanca GM 15401 (Shank hook with point and latch GM 15401)	Kodu & Nr Code & Nr	Nr 5	Miktar Quantity	30
----------------------------	---	------------------------	------	--------------------	----

Malzeme Kalite Sınıfı (Material of quality class)	T	Malzeme Kalitesi (Material of quality)	42CRMO4	Döküm No (Cast No)	41165
--	---	---	---------	-----------------------	-------

KANCA ÇALIŞMA ARALIĞI
KG

	1Bm/M3	1Am/M4	2m/M5	3m/M6	4m/M7	5m/M8
Saatteki Çalışma Sayısı (Number of working in hour)	6'ya kadar (to 6)	6 ile 18 Arası (6 to 18)	18 ile 30 arası (18 to 30)	30 ile 60 arası (30 to 60)	60'dan fazla (More than 60)	Aralıksız Çalışma
	20.000	16.000	12.500	10.000	8.000	0

Kimyasal Analiz (pota, % Ağırlık) (Chemical analysis (ladle, weight %))
--

Element % Elements %										
C	Si	Mn	P	S	Cr	Mo	Ni	Cu	Al	N
0,43	0,27	0,89	0,014	0,002	1	0,23	0,07	0,2	0,024	

Çekme Dayanımı (Tensile Strength) Rm (N/mm ²)	Akma Dayanımı (Yield Strength ReH) (N/mm ²)	Uzama (Elongation) N/mm ²	Çentik Enerjisi (Impact Energy) -20° ISO-V
1066	995	18	

Su Verme ve Temperleme (quench and tempering)	Ok	Normalizasyon (Normalized)	
--	----	-------------------------------	--

Açıklama (Remarks)	Mustafa Şenol (Signature)
-----------------------	------------------------------



CERTIFICATE OF CONFORMITY
Certificate No: 15-PS-012-TAT-15-MAD-032

Applicant: GÜNEŞ MAKİNA SANAYİ VE TİCARİET LTD.ŞTİ.
DEĞ. SANAYİ BİTİRE 106. SK. B13 BLOK NO: 4
YILDIZLIU - İSTANBUL - TÜRKİYE

Product: BRUSHES

Type/Models: # BRUSH HOOK (GM 322) (S*) - 21 #
BRUSH EYE (GM 321) (S*) - 21 #
HOOK AND EYE (GM 322) (S*) - 45 #
HOOK AND EYE (GM 321) (S*) - 45 #
EYE AND EYE (GM 321) (S*) - 45 #
EYE AND EYE (GM 321) (S*) - 45

Standards / Certification Basis: 2006/42/EC Machinery Directive
EN ISO 12100:2010
EN 1077-2:2004+A1:2008

Test Report No: 15-PS-012-08-002
First Issue Date: 30.03.2016 - 15-PS-012-TAT-15-MAD-032
Renewal Date: 30.03.2016
Expiry Date: 30.03.2017

Prepared By: [Signature]
Approved By: [Signature]
Head of TÜV Services

CE

After preparation of the necessary technical documentation as well as the declaration of conformity the required CE marking can be affixed on the product. Other relevant directives have to be observed.

This Certificate of Conformity has been granted to the applicant based on the results of testing performed by the applicant/manufacture or an accepted laboratory and the consequent review of the test report by TÜV Austria Turk. Reference to the referenced certification basis or any change of the design, materials, components or processing may require the repetition of all or some of the qualification tests in order to be test report and therefore the associated certificate to remain valid.

CERTIFICATE OF CONFORMITY
Certificate No: 15-PS-012-TAT-15-MAD-036

Applicant: GÜNEŞ MAKİNA SANAYİ VE TİCARİET LTD.ŞTİ.
DEĞ. SANAYİ BİTİRE 106. SK. B13 BLOK NO: 4
YILDIZLIU - İSTANBUL - TÜRKİYE

Product: TURNBUCKLES

Type/Models: # JAW & JAW TURNBUCKLES (GM 478) (S*) - 44 #
JAW & JAW TURNBUCKLES OPEN TYPE (GM 478) (S*) - 44 #
EYE & TURNBUCKLES (GM 482) (S*) - 44 #
EYE & EYE TURNBUCKLES OPEN TYPE (GM 482) (S*) - 44

Standards / Certification Basis: 2006/42/EC Machinery Directive
EN ISO 12100:2010
EN 1077-2:2004+A1:2008

Test Report No: 15-PS-012-08-002
First Issue Date: 30.03.2016 - 15-PS-012-TAT-15-MAD-036
Renewal Date: 30.03.2016
Expiry Date: 30.03.2017

Prepared By: [Signature]
Approved By: [Signature]
Head of TÜV Services

CE

After preparation of the necessary technical documentation as well as the declaration of conformity the required CE marking can be affixed on the product. Other relevant directives have to be observed.

This Certificate of Conformity has been granted to the applicant based on the results of testing performed by the applicant/manufacture or an accepted laboratory and the consequent review of the test report by TÜV Austria Turk. Reference to the referenced certification basis or any change of the design, materials, components or processing may require the repetition of all or some of the qualification tests in order to be test report and therefore the associated certificate to remain valid.

CERTIFICATE OF CONFORMITY
Certificate No: 15-PS-012-TAT-15-MAD-033

Applicant: GÜNEŞ MAKİNA SANAYİ VE TİCARİET LTD.ŞTİ.
DEĞ. SANAYİ BİTİRE 106. SK. B13 BLOK NO: 4
YILDIZLIU - İSTANBUL - TÜRKİYE

Product: SOCKET FOR WIRE ROPE

Type/Models: # OPEN TYPE (GM 418) (F*) - 21 #
CLOSED TYPE (GM 417) (F*) - 21 #
WIRE ROPE TYPE (GM 422) (S*) - 101

Standards / Certification Basis: 2006/42/EC Machinery Directive
EN ISO 12100:2010
EN 1077-2:2004+A1:2008

Test Report No: 15-PS-012-08-003
First Issue Date: 30.03.2016 - 15-PS-012-TAT-15-MAD-033
Renewal Date: 30.03.2016
Expiry Date: 30.03.2017

Prepared By: [Signature]
Approved By: [Signature]
Head of TÜV Services

CE

After preparation of the necessary technical documentation as well as the declaration of conformity the required CE marking can be affixed on the product. Other relevant directives have to be observed.

This Certificate of Conformity has been granted to the applicant based on the results of testing performed by the applicant/manufacture or an accepted laboratory and the consequent review of the test report by TÜV Austria Turk. Reference to the referenced certification basis or any change of the design, materials, components or processing may require the repetition of all or some of the qualification tests in order to be test report and therefore the associated certificate to remain valid.

CERTIFICATE OF CONFORMITY
Certificate No: 15-PS-012-TAT-15-MAD-032

Applicant: GÜNEŞ MAKİNA SANAYİ VE TİCARİET LTD.ŞTİ.
DEĞ. SANAYİ BİTİRE 106. SK. B13 BLOK NO: 4
YILDIZLIU - İSTANBUL - TÜRKİYE

Product: EYE TYPE METRIC BOLT AND NUTS

Type/Models: # EYE BOLT (GM 585) (M) - M10x1.5 #
EYE NUTS (GM 585) (M) - M10x1.5

Standards / Certification Basis: 2006/42/EC Machinery Directive
EN ISO 12100:2010
EN 1077-2:2004+A1:2008
EN 15013

Test Report No: 15-PS-012-08-004
First Issue Date: 30.03.2016 - 15-PS-012-TAT-15-MAD-032
Renewal Date: 30.03.2016
Expiry Date: 30.03.2017

Prepared By: [Signature]
Approved By: [Signature]
Head of TÜV Services

CE

After preparation of the necessary technical documentation as well as the declaration of conformity the required CE marking can be affixed on the product. Other relevant directives have to be observed.

This Certificate of Conformity has been granted to the applicant based on the results of testing performed by the applicant/manufacture or an accepted laboratory and the consequent review of the test report by TÜV Austria Turk. Reference to the referenced certification basis or any change of the design, materials, components or processing may require the repetition of all or some of the qualification tests in order to be test report and therefore the associated certificate to remain valid.

CERTIFICATE OF CONFORMITY
Certificate No: 15-PS-012-TAT-15-MAD-033

Applicant: GÜNEŞ MAKİNA SANAYİ VE TİCARİET LTD.ŞTİ.
DEĞ. SANAYİ BİTİRE 106. SK. B13 BLOK NO: 4
YILDIZLIU - İSTANBUL - TÜRKİYE

Product: STEEL RINGS

Type/Models: # OVAL RINGS (GM 340) (S*) - 21 #
OVAL RING (GM 340) (S*) - 45 #
D TYPE RINGS (GM 340) (S*) - 21

Standards / Certification Basis: 2006/42/EC Machinery Directive
EN ISO 12100:2010
EN 1077-2:2004+A1:2008

Test Report No: 15-PS-012-08-005
First Issue Date: 30.03.2016 - 15-PS-012-TAT-15-MAD-032
Renewal Date: 30.03.2016
Expiry Date: 30.03.2017

Prepared By: [Signature]
Approved By: [Signature]
Head of TÜV Services

CE

After preparation of the necessary technical documentation as well as the declaration of conformity the required CE marking can be affixed on the product. Other relevant directives have to be observed.

This Certificate of Conformity has been granted to the applicant based on the results of testing performed by the applicant/manufacture or an accepted laboratory and the consequent review of the test report by TÜV Austria Turk. Reference to the referenced certification basis or any change of the design, materials, components or processing may require the repetition of all or some of the qualification tests in order to be test report and therefore the associated certificate to remain valid.

CERTIFICATE OF CONFORMITY
Certificate No: 15-PS-012-TAT-15-MAD-034

Applicant: GÜNEŞ MAKİNA SANAYİ VE TİCARİET LTD.ŞTİ.
DEĞ. SANAYİ BİTİRE 106. SK. B13 BLOK NO: 4
YILDIZLIU - İSTANBUL - TÜRKİYE

Product: HOOKS AND HOOK TRAVELERS

Type/Models: # HOOK AND HOOK TRAVELER (GM 1447) (M) - 101 #
HOOK AND HOOK TRAVELER (GM 1447) (M) - 101 #
HOOK AND HOOK TRAVELER (GM 1447) (M) - 101 #
HOOK AND HOOK TRAVELER (GM 1447) (M) - 101 #
HOOK AND HOOK TRAVELER (GM 1447) (M) - 101

Standards / Certification Basis: 2006/42/EC Machinery Directive
EN ISO 12100:2010
EN 10423:1999
EN 10423:1999
EN 10423:1999
EN 10423:1999
EN 10423:1999
EN 1077-2:2004+A1:2008
EN 1077-2:2004+A1:2008

Test Report No: 15-PS-012-08-006
First Issue Date: 30.03.2016 - 15-PS-012-TAT-15-MAD-033
Renewal Date: 30.03.2016
Expiry Date: 30.03.2017

Prepared By: [Signature]
Approved By: [Signature]
Head of TÜV Services

CE

After preparation of the necessary technical documentation as well as the declaration of conformity the required CE marking can be affixed on the product. Other relevant directives have to be observed.

This Certificate of Conformity has been granted to the applicant based on the results of testing performed by the applicant/manufacture or an accepted laboratory and the consequent review of the test report by TÜV Austria Turk. Reference to the referenced certification basis or any change of the design, materials, components or processing may require the repetition of all or some of the qualification tests in order to be test report and therefore the associated certificate to remain valid.

CERTIFICATE OF CONFORMITY
Certificate No: 15-PS-012-TAT-15-MAD-035

Applicant: GÜNEŞ MAKİNA SANAYİ VE TİCARİET LTD.ŞTİ.
DEĞ. SANAYİ BİTİRE 106. SK. B13 BLOK NO: 4
YILDIZLIU - İSTANBUL - TÜRKİYE

Product: BRUSHES

Type/Models: # BRUSH TYPE WITH SCREW #
GM 210 (S*) - 41 #
BRUSH TYPE WITH SCREW #
GM 210 (S*) - 41 #
BRUSH TYPE WITH SCREW #
GM 210 (S*) - 41 #
BRUSH TYPE WITH SCREW #
GM 210 (S*) - 41

Standards / Certification Basis: 2006/42/EC Machinery Directive
EN ISO 12100:2010
EN 1077-2:2004+A1:2008

Test Report No: 15-PS-012-08-007
First Issue Date: 30.03.2016 - 15-PS-012-TAT-15-MAD-034
Renewal Date: 30.03.2016
Expiry Date: 30.03.2017

Prepared By: [Signature]
Approved By: [Signature]
Head of TÜV Services

CE

After preparation of the necessary technical documentation as well as the declaration of conformity the required CE marking can be affixed on the product. Other relevant directives have to be observed.

This Certificate of Conformity has been granted to the applicant based on the results of testing performed by the applicant/manufacture or an accepted laboratory and the consequent review of the test report by TÜV Austria Turk. Reference to the referenced certification basis or any change of the design, materials, components or processing may require the repetition of all or some of the qualification tests in order to be test report and therefore the associated certificate to remain valid.

CERTIFICATE OF CONFORMITY
Certificate No: 15-PS-012-TAT-15-MAD-036

Applicant: GÜNEŞ MAKİNA SANAYİ VE TİCARİET LTD.ŞTİ.
DEĞ. SANAYİ BİTİRE 106. SK. B13 BLOK NO: 4
YILDIZLIU - İSTANBUL - TÜRKİYE

Product: PULLEYS

Type/Models: # CARDS BLOCK (GM 1405) (M) - 101 #
SNATCH BLOCK (GM 1405) (M) - 101 #
STEEL CONTROL (GM 1411) (S*) - 21 #
JAPANESE TYPE SNATCH (GM 1422) (S*) - 21

Standards / Certification Basis: 2006/42/EC Machinery Directive
EN ISO 12100:2010
EN 1077-2:2004+A1:2008

Test Report No: 15-PS-012-08-008
First Issue Date: 30.03.2016 - 15-PS-012-TAT-15-MAD-035
Renewal Date: 30.03.2016
Expiry Date: 30.03.2017

Prepared By: [Signature]
Approved By: [Signature]
Head of TÜV Services

CE

After preparation of the necessary technical documentation as well as the declaration of conformity the required CE marking can be affixed on the product. Other relevant directives have to be observed.

This Certificate of Conformity has been granted to the applicant based on the results of testing performed by the applicant/manufacture or an accepted laboratory and the consequent review of the test report by TÜV Austria Turk. Reference to the referenced certification basis or any change of the design, materials, components or processing may require the repetition of all or some of the qualification tests in order to be test report and therefore the associated certificate to remain valid.

INSPECCO

CERTIFICATE

This is to certify that the Quality Management System of

GÜNEŞ MAKİNA SAN. ve TİC. LTD. ŞTİ.

Des Sanayi Sitesi 106. Sok. B13 Blok No:3-4 Ümraniye-İstanbul (Turkey) has been assessed and approved by Inspecco Certification and Inspection Services Co. Ltd against the following standard

ISO 9001:2008
Extension: F.3

The Quality Management System is applicable to

Manufacturing of lifting, carrying, stretching equipment, steel wire rope, press crushing slings and chain slings accessories

Certificate No: 06.58-10-038/09/1
Certificate valid from: 06.08.2016
Certificate valid until: 06.08.2019

General Manager: [Signature]

www.inspecco.com



Güneş Makina®





Güneş Makina®

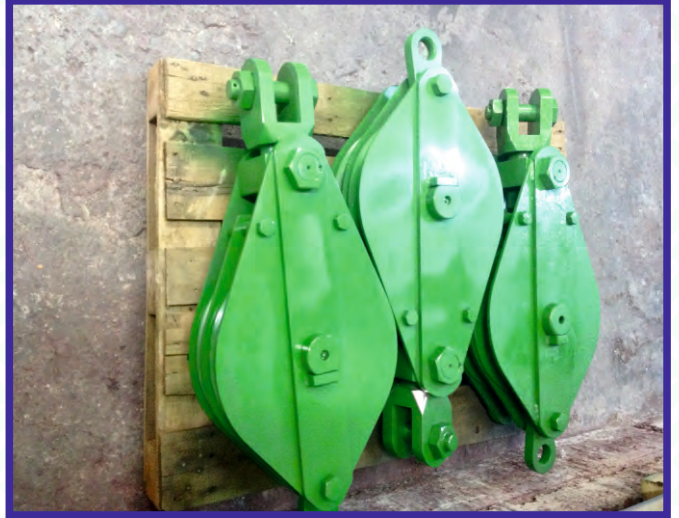



Güneş Makina®



Test Machine
Capacite 170 Tons
Lenth 20 metre





Güneş Makina®



INSPECCO
ISO 9001

TÜV
AUSTRIA

ДОБРОВОЛНАТА
PG
СЕРТИФИКАЦИЯ

CE

TSE
NDT
Test Calibration

www.gunesmakina.com



Güneş Makina®





Güneş Makina®





Güneş Makina®

SHOWROOM:

Organize Sanayi Bölgesi Des Sanayi Sitesi 106 Sk. B12 No: 8 Y.Dudullu - Ümraniye - İSTANBUL / TÜRKİYE
Tel: +90 216 420 21 00 - 420 21 01 Fax: +90 216 420 21 02

FACTORY:

Organize Sanayi Bölgesi Des Sanayi Sitesi 106 Sk. B13 No: 2-4 Y.Dudullu - Ümraniye - İSTANBUL / TÜRKİYE
Tel: +90 216 313 07 76 Fax: +90 0216 420 21 02

www.gunesmakina.com - info@gunesmakina.com